

Retaining Wall on Boundary
 Max Height : 0.45m
 Min Height : 0.40m
 Average Height : 0.43m

Retaining Wall in Lot 74
 Max Height : 1.01m
 Min Height : 0.38m
 Average Height : 0.70m

LEGEND

- Area of Cut
- Area of Fill
- Finished Surface Contours
- Depth of Fill Contours
- Retaining Wall (Height shown on lower side of wall)
- Proposed Earthworks Pad
- Finished Design Surface Level
- Future Lot Boundary

Not all items in this legend may be relevant to the lot shown on this plan.

NOTES

This plan has been prepared from preliminary survey plan (SP317659) and engineering data provided on the 09/07/2020 by Peak Urban Engineers.

Development approval has been received for this subdivision (application 2558/4/MAMC/C) from Ipswich City Council (13/06/2019).

Development approval has been granted for Operational Works for this lot.

All fill shall be placed and compacted in a controlled manner so that Level 1 level of responsibility may be achieved and certified as per AS3798-2007.

Issues	No.	by	Date	Description
A	TBG		25/06/20	Original Issue
B	TBG		20/07/20	Civil Design Update

SCALE @ A3 1:200 - LENGTHS ARE IN METRES

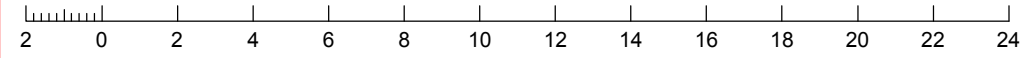

SH saunders havill group
 Saunders Havill Group Pty Ltd ABN 24 144 972 949
 Brisbane • Springfield • Rockhampton
 head office 9 Thompson St Bowen Hills Q 4006
 phone 1300 123 SHG web www.saundershavill.com
 ■ surveying ■ town planning ■ urban design ■ environmental management ■ landscape architecture

This Disclosure Plan is prepared for the sole purpose of satisfying the Disclosure requirements of the Land Sales Act and SHOULD NOT be used for any other purpose, particularly As-constructed purposes. This information is compiled from Design plans only, unless otherwise stated, and therefore is subject to final survey and construction of operational works.

Disclosure Plan for Proposed Lot 74 on SP317659
 Described as part of Lot 5007 on SP312157
 Existing Title Reference: 51216954
 Locality of Collingwood Park (Ipswich City Council)

Level Datum: AHD der.
 Origin of Levels: PM203097
 RL of Origin: 45.557m
 Contour Interval: 0.25m
 Scale @A3 1: 200
 Dwg No. 6777 S 37 DP B_74

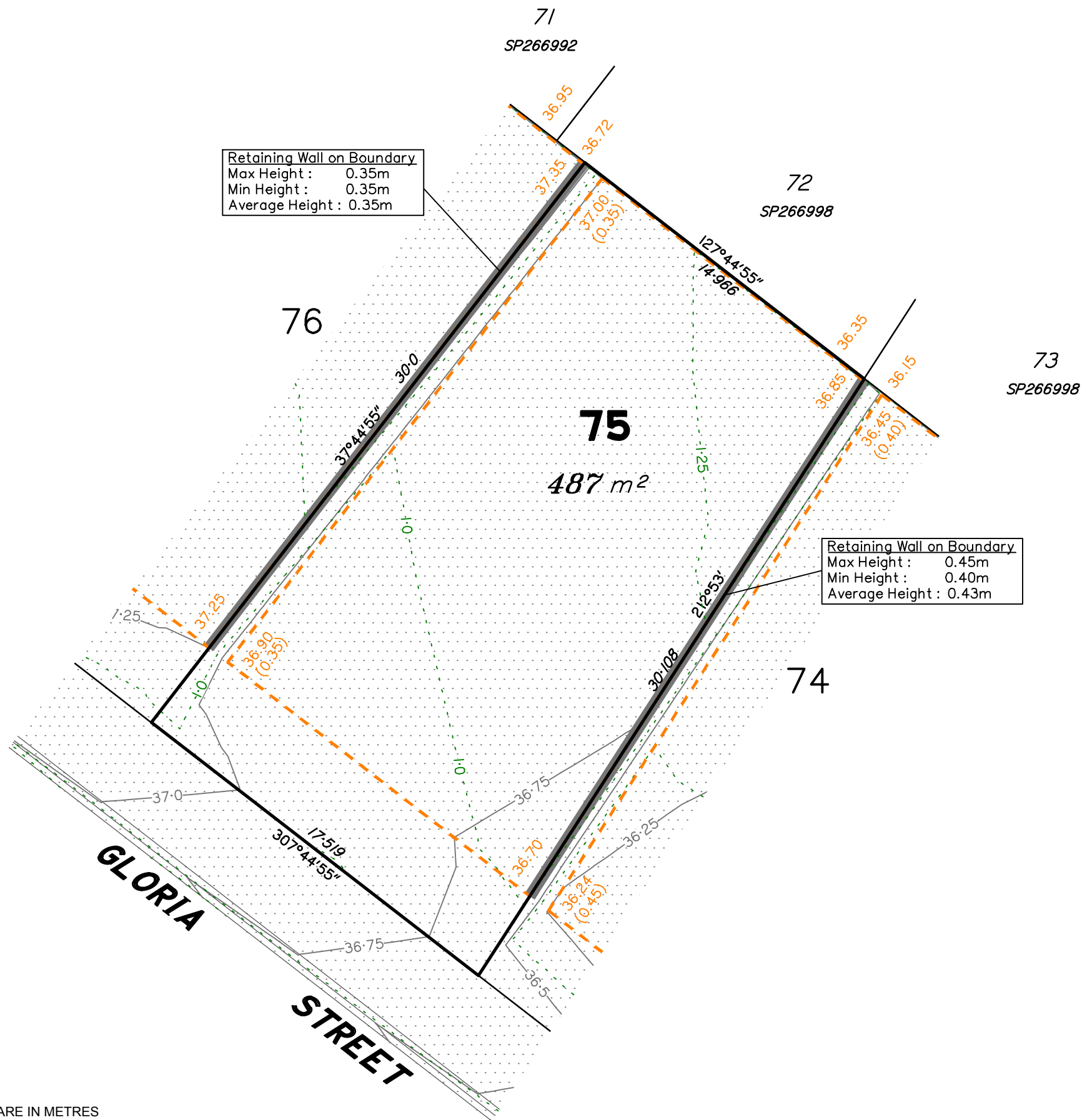
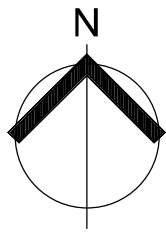

LEGEND

- Area of Cut
- Area of Fill
- Finished Surface Contours
- Depth of Fill Contours
- Retaining Wall (Height shown on lower side of wall)
- Proposed Earthworks Pad
- 38.78 Finished Design Surface Level
- Future Lot Boundary

Not all items in this legend may be relevant to the lot shown on this plan.

NOTES

This plan has been prepared from preliminary survey plan (SP317659) and engineering data provided on the 09/07/2020 by Peak Urban Engineers.

Development approval has been received for this subdivision (application 2558/4/MAMC/C) from Ipswich City Council (13/06/2019).

Development approval has been granted for Operational Works for this lot.

All fill shall be placed and compacted in a controlled manner so that Level 1 level of responsibility may be achieved and certified as per AS3798-2007.

SCALE @ A3 1:200 - LENGTHS ARE IN METRES

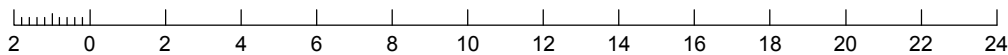

Issues	No.	by	Date	Description
A	TBG		25/06/20	Original Issue
B	TBG		20/07/20	Civil Design Update



Saunders Havill Group Pty Ltd ABN 24 144 972 949
 Brisbane • Springfield • Rockhampton
 head office 9 Thompson St Bowen Hills Q 4006
 phone 1300 123 SHG web www.saundershavill.com

• surveying • town planning • urban design • environmental management • landscape architecture

This Disclosure Plan is prepared for the sole purpose of satisfying the Disclosure requirements of the Land Sales Act and SHOULD NOT be used for any other purpose, particularly As-constructed purposes. This information is compiled from Design plans only, unless otherwise stated, and therefore is subject to final survey and construction of operational works.

Disclosure Plan for Proposed Lot 75 on SP317659

Described as part of Lot 5007 on SP312157
 Existing Title Reference: 51216954

Locality of Collingwood Park (Ipswich City Council)

Level Datum: AHD der.
 Origin of Levels: PM203097
 RL of Origin: 45.557m
 Contour Interval: 0.25m

Scale @A3 1: 200
 Dwg No. 6777 S 37 DP B_75

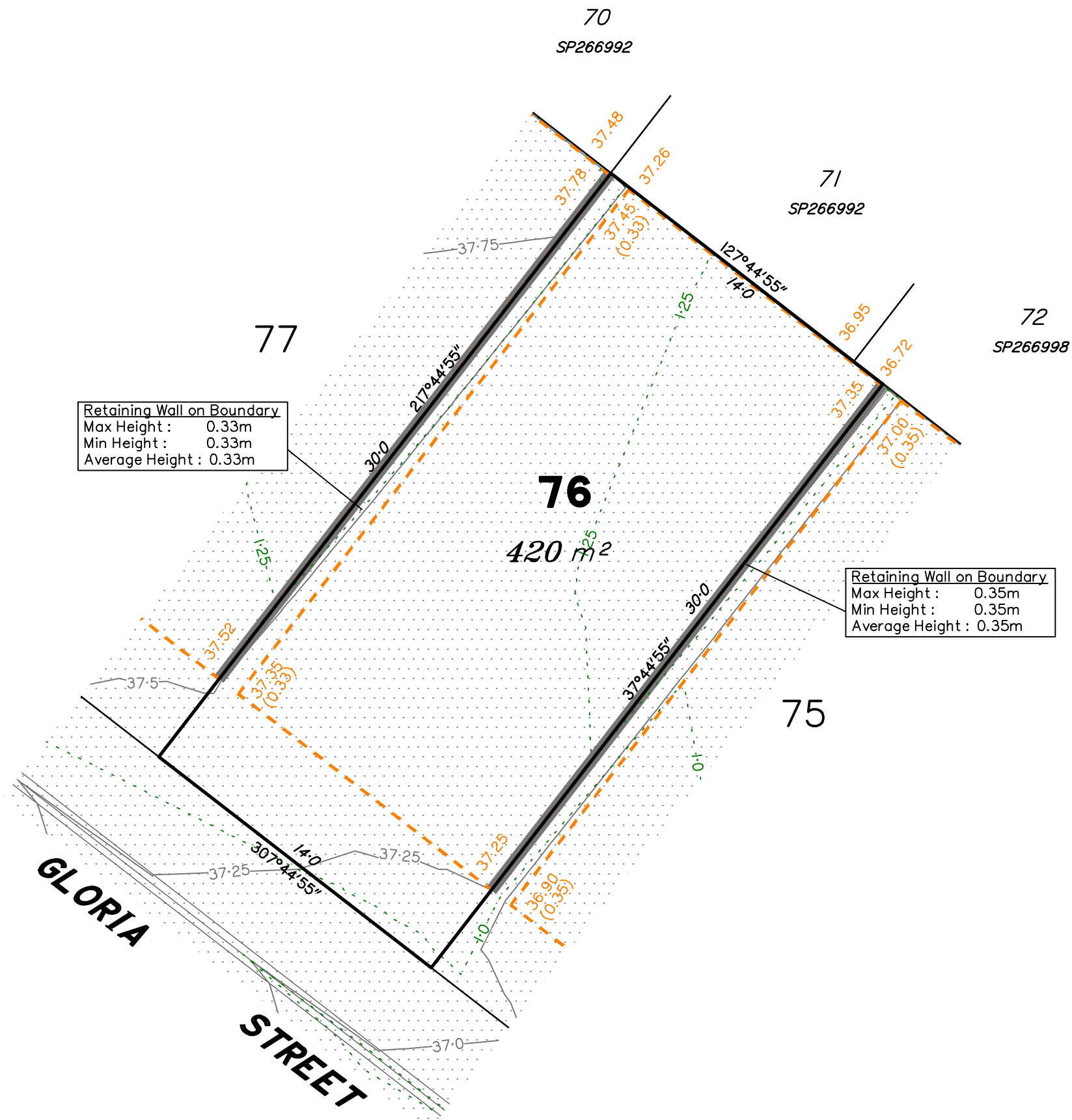

Retaining Wall on Boundary
 Max Height : 0.33m
 Min Height : 0.33m
 Average Height : 0.33m

Retaining Wall on Boundary
 Max Height : 0.35m
 Min Height : 0.35m
 Average Height : 0.35m

LEGEND

- Area of Cut
- Area of Fill
- Finished Surface Contours
- Depth of Fill Contours
- Retaining Wall (Height shown on lower side of wall)
- Proposed Earthworks Pad
- 38.78 Finished Design Surface Level
- Future Lot Boundary

Not all items in this legend may be relevant to the lot shown on this plan.

NOTES

This plan has been prepared from preliminary survey plan (SP317659) and engineering data provided on the 09/07/2020 by Peak Urban Engineers.

Development approval has been received for this subdivision (application 2558/4/MAMC/C) from Ipswich City Council (13/06/2019).

Development approval has been granted for Operational Works for this lot.

All fill shall be placed and compacted in a controlled manner so that Level 1 level of responsibility may be achieved and certified as per AS3798-2007.

No.	by	Date	Description
A	TBG	25/06/20	Original Issue
B	TBG	20/07/20	Civil Design Update

SCALE @ A3 1:200 - LENGTHS ARE IN METRES

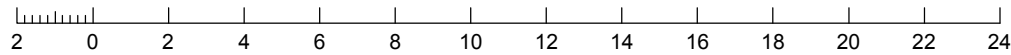

Saunders Havill Group Pty Ltd ABN 24 144 972 949
 Brisbane ● Springfield ● Rockhampton
 head office 9 Thompson St Bowen Hills Q 4006
 phone 1300 123 SHG web www.saundershavill.com

● surveying ● town planning ● urban design ● environmental management ● landscape architecture

This Disclosure Plan is prepared for the sole purpose of satisfying the Disclosure requirements of the Land Sales Act and SHOULD NOT be used for any other purpose, particularly As-constructed purposes. This information is compiled from Design plans only, unless otherwise stated, and therefore is subject to final survey and construction of operational works.

Disclosure Plan for Proposed Lot 76 on SP317659

Described as part of Lot 5007 on SP312157
 Existing Title Reference: 51216954

Locality of Collingwood Park (Ipswich City Council)

Level Datum: AHD der.
 Origin of Levels: PM203097
 RL of Origin: 45.557m
 Contour Interval: 0.25m

Scale @A3 1: 200
 Dwg No. 6777 S 37 DP B_76

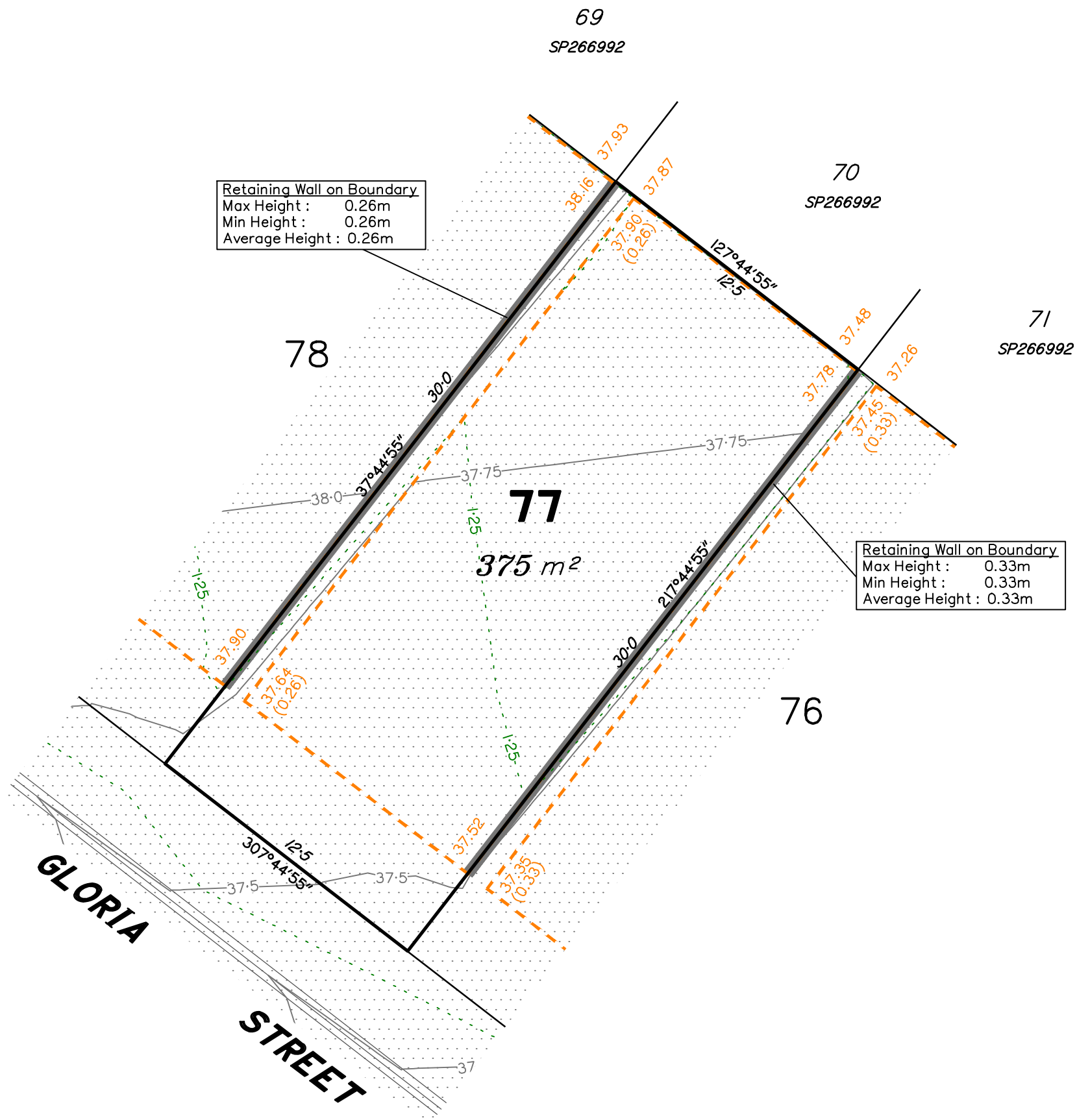
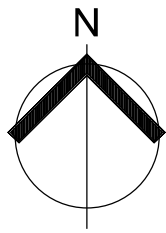

LEGEND

- Area of Cut
- Area of Fill
- Finished Surface Contours
- Depth of Fill Contours
- Retaining Wall (Height shown on lower side of wall)
- Proposed Earthworks Pad
- 38.78 Finished Design Surface Level
- Future Lot Boundary

Not all items in this legend may be relevant to the lot shown on this plan.

NOTES

This plan has been prepared from preliminary survey plan (SP317659) and engineering data provided on the 09/07/2020 by Peak Urban Engineers.

Development approval has been received for this subdivision (application 2558/4/MAMC/C) from Ipswich City Council (13/06/2019).

Development approval has been granted for Operational Works for this lot.

All fill shall be placed and compacted in a controlled manner so that Level 1 level of responsibility may be achieved and certified as per AS3798-2007.

SCALE @ A3 1:200 - LENGTHS ARE IN METRES

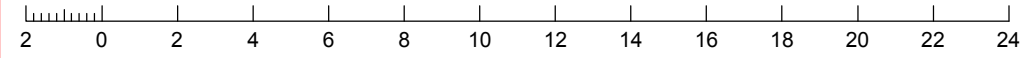

Issues	No.	by	Date	Description
A	TBG		25/06/20	Original Issue
B	TBG		20/07/20	Civil Design Update

SH saunders havill group
 Saunders Havill Group Pty Ltd ABN 24 144 972 949
 Brisbane • Springfield • Rockhampton
 head office 9 Thompson St Bowen Hills Q 4006
 phone 1300 123 SHG web www.saundershavill.com
 • surveying • town planning • urban design • environmental management • landscape architecture

This Disclosure Plan is prepared for the sole purpose of satisfying the Disclosure requirements of the Land Sales Act and SHOULD NOT be used for any other purpose, particularly As-constructed purposes. This information is compiled from Design plans only, unless otherwise stated, and therefore is subject to final survey and construction of operational works.

Disclosure Plan for Proposed Lot 77 on SP317659
 Described as part of Lot 5007 on SP312157
 Existing Title Reference: 51216954
 Locality of Collingwood Park (Ipswich City Council)

Level Datum: AHD der.
 Origin of Levels: PM203097
 RL of Origin: 45.557m
 Contour Interval: 0.25m
 Scale @A3 1: 200
 Dwg No. 6777 S 37 DP B_77

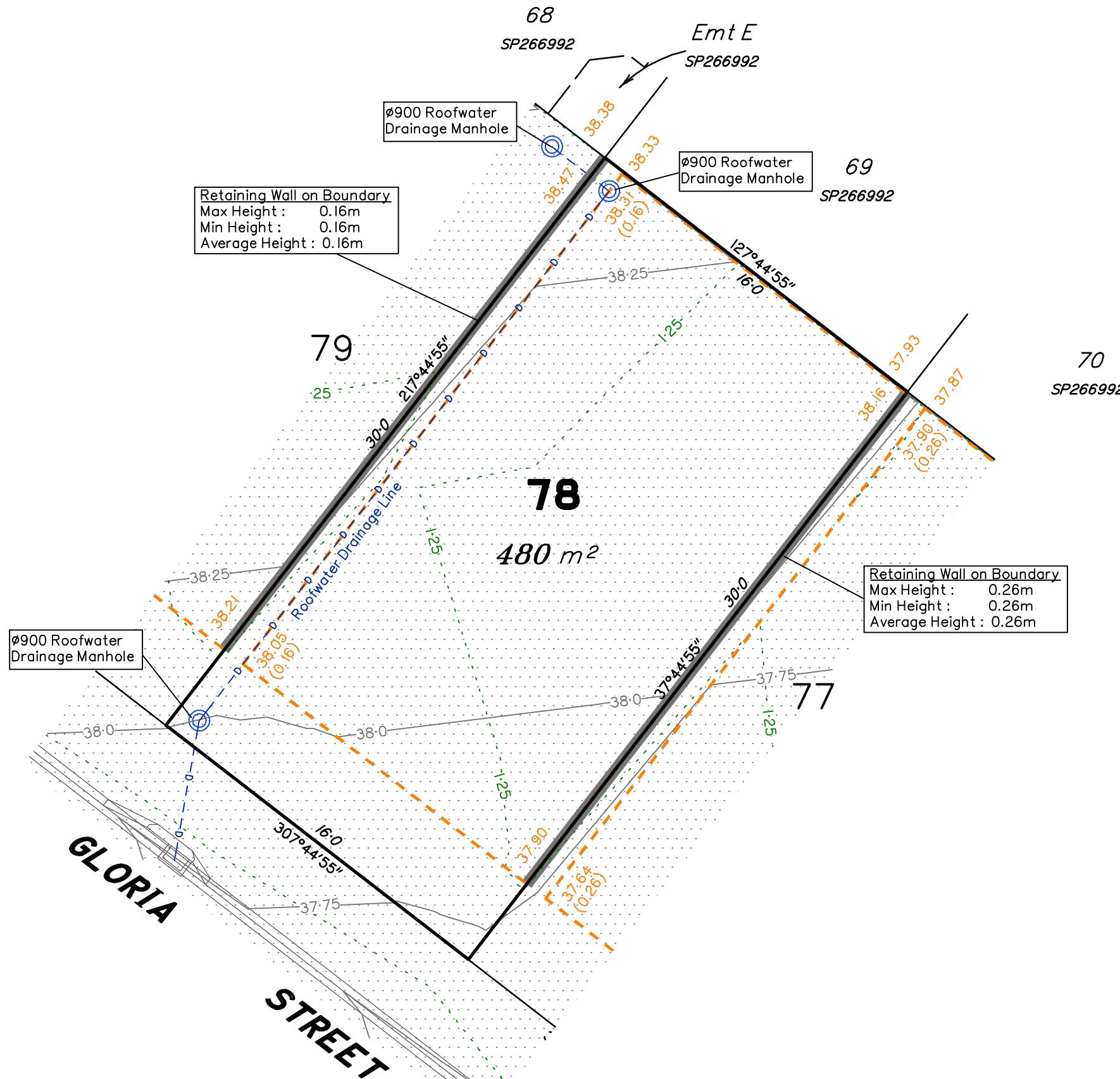
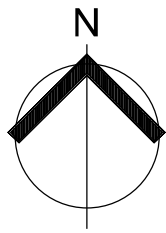

LEGEND

- Area of Cut
- Area of Fill
- Finished Surface Contours
- Depth of Fill Contours
- Retaining Wall (Height shown on lower side of wall)
- Proposed Earthworks Pad
- 38.78 Finished Design Surface Level
- Future Lot Boundary

Not all items in this legend may be relevant to the lot shown on this plan.

NOTES

This plan has been prepared from preliminary survey plan (SP317659) and engineering data provided on the 09/07/2020 by Peak Urban Engineers.

Development approval has been received for this subdivision (application 2558/4/MAMC/C) from Ipswich City Council (13/06/2019).

Development approval has been granted for Operational Works for this lot.

All fill shall be placed and compacted in a controlled manner so that Level 1 level of responsibility may be achieved and certified as per AS3798-2007.

Issues	No.	by	Date	Description
A	TBG		25/06/20	Original Issue
B	TBG		20/07/20	Civil Design Update

SCALE @ A3 1:200 - LENGTHS ARE IN METRES

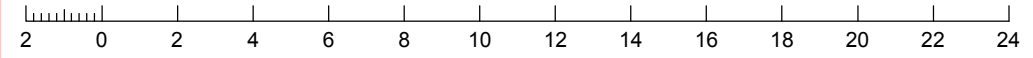

SH saunders havill group
 Saunders Havill Group Pty Ltd ABN 24 144 972 949
 Brisbane • Springfield • Rockhampton
 head office 9 Thompson St Bowen Hills Q 4006
 phone 1300 123 5HG web www.saundershavill.com
 • surveying • town planning • urban design • environmental management • landscape architecture

This Disclosure Plan is prepared for the sole purpose of satisfying the Disclosure requirements of the Land Sales Act and SHOULD NOT be used for any other purpose, particularly As-constructed purposes. This information is compiled from Design plans only, unless otherwise stated, and therefore is subject to final survey and construction of operational works.

Disclosure Plan for Proposed Lot 78 on SP317659
 Described as part of Lot 5007 on SP312157
 Existing Title Reference: 51216954
 Locality of Collingwood Park (Ipswich City Council)

Level Datum: AHD der.
 Origin of Levels: PM203097
 RL of Origin: 45.557m
 Contour Interval: 0.25m
 Scale @A3 1: 200
 Dwg No. 6777 S 37 DP B_78

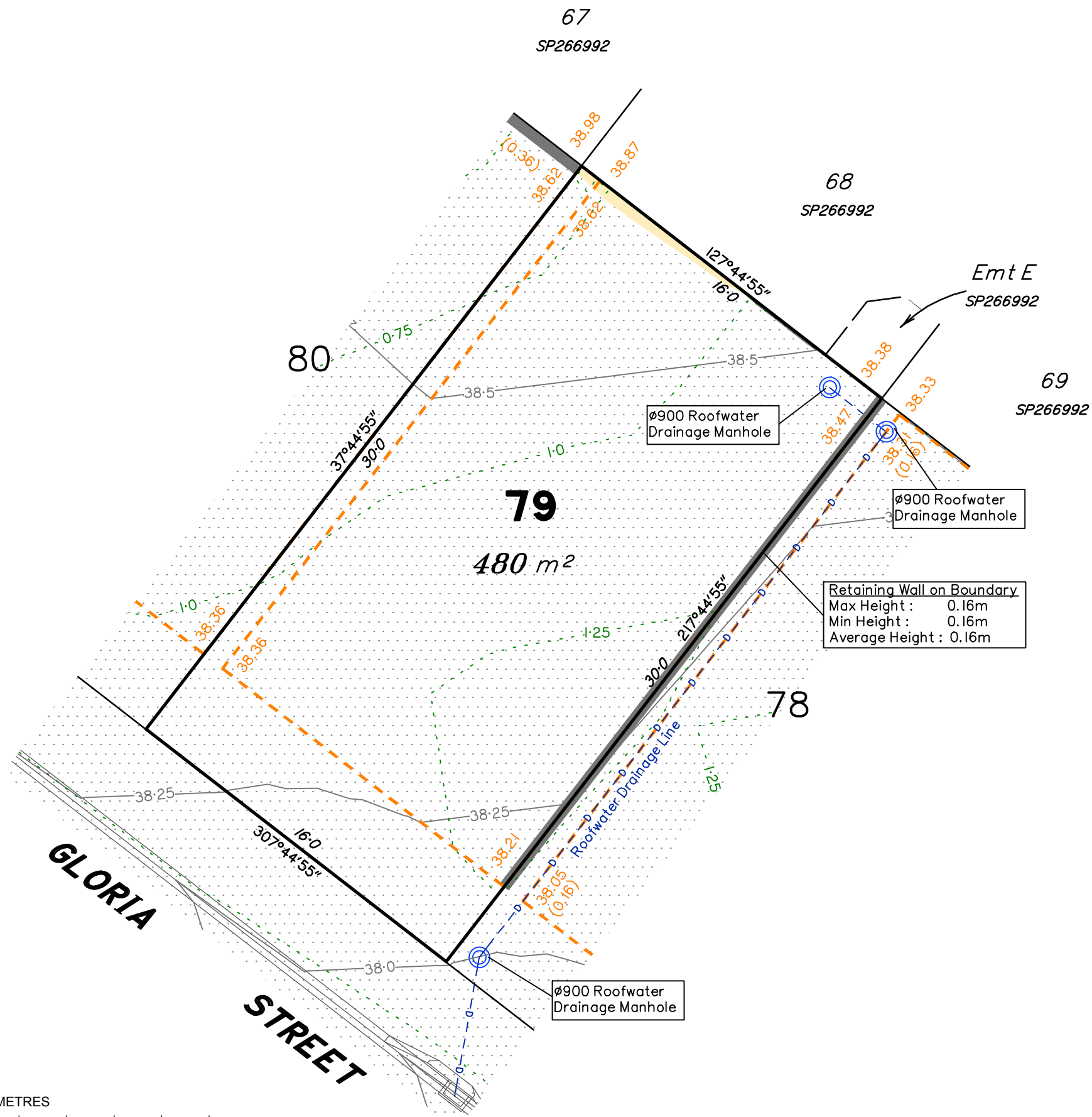
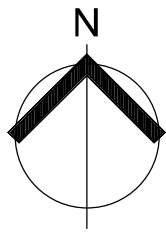

LEGEND

- Area of Cut
- Area of Fill
- Finished Surface Contours
- Depth of Fill Contours
- Retaining Wall
(Height shown on lower side of wall)
- Proposed Earthworks Pad
- 38.78 Finished Design Surface Level
- Future Lot Boundary

Not all items in this legend may be relevant to the lot shown on this plan.

NOTES

This plan has been prepared from preliminary survey plan (SP317659) and engineering data provided on the 09/07/2020 by Peak Urban Engineers.

Development approval has been received for this subdivision (application 2558/4/MAMC/C) from Ipswich City Council (13/06/2019).

Development approval has been granted for Operational Works for this lot.

All fill shall be placed and compacted in a controlled manner so that Level 1 level of responsibility may be achieved and certified as per AS3798-2007.

SCALE @ A3 1:200 - LENGTHS ARE IN METRES

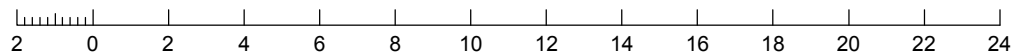

No.	by	Date	Description
A	TBG	25/06/20	Original Issue
B	TBG	20/07/20	Civil Design Update



Saunders Havill Group Pty Ltd ABN 24 144 972 949
 Brisbane ● Springfield ● Rockhampton
 head office 9 Thompson St Bowen Hills Q 4006
 phone 1300 123 5HG web www.saundershavill.com

● surveying ● town planning ● urban design ● environmental management ● landscape architecture

This Disclosure Plan is prepared for the sole purpose of satisfying the Disclosure requirements of the Land Sales Act and SHOULD NOT be used for any other purpose, particularly As-constructed purposes. This information is compiled from Design plans only, unless otherwise stated, and therefore is subject to final survey and construction of operational works.

Disclosure Plan for Proposed Lot 79 on SP317659

Described as part of Lot 5007 on SP312157
 Existing Title Reference: 51216954

Locality of Collingwood Park (Ipswich City Council)

Level Datum: AHD der.
 Origin of Levels: PM203097
 RL of Origin: 45.557m
 Contour Interval: 0.25m

Scale @A3 1: 200
 Dwg No. 6777 S 37 DP B_79

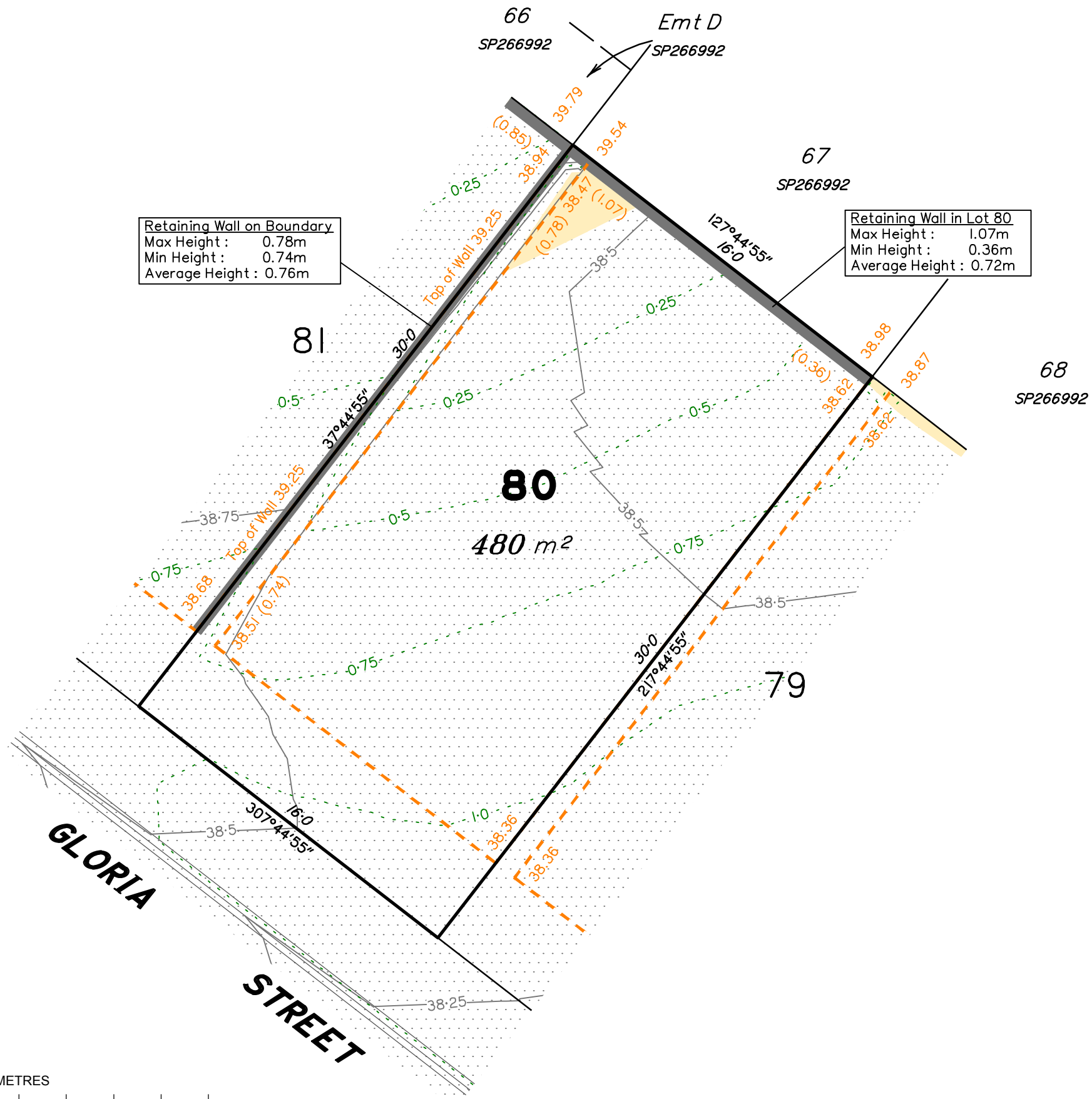

LEGEND

- Area of Cut
- Area of Fill
- Finished Surface Contours
- Depth of Fill Contours
- Retaining Wall (Height shown on lower side of wall)
- Proposed Earthworks Pad
- 38.78 Finished Design Surface Level
- Future Lot Boundary

Not all items in this legend may be relevant to the lot shown on this plan.

NOTES

This plan has been prepared from preliminary survey plan (SP317659) and engineering data provided on the 23/09/2020 by Peak Urban Engineers.

Development approval has been received for this subdivision (application 2558/4/MAMC/C) from Ipswich City Council (13/06/2019).

Development approval has been granted for Operational Works for this lot.

All fill shall be placed and compacted in a controlled manner so that Level 1 level of responsibility may be achieved and certified as per AS3798-2007.

Issues	No.	by	Date	Description
A	TBG		25/06/20	Original Issue
B	TBG		20/07/20	Civil Design Update
C	TBG		24/09/20	Ret Wall Update

SCALE @ A3 1:200 - LENGTHS ARE IN METRES

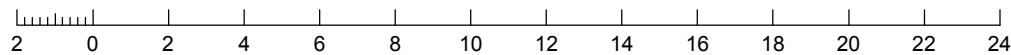

Saunders Havill Group Pty Ltd ABN 24 144 972 949
 Brisbane ● Springfield ● Rockhampton
 head office 9 Thompson St Bowen Hills Q 4006
 phone 1300 123 SHG web www.saundershavill.com

● surveying ● town planning ● urban design ● environmental management ● landscape architecture

This Disclosure Plan is prepared for the sole purpose of satisfying the Disclosure requirements of the Land Sales Act and SHOULD NOT be used for any other purpose, particularly As-constructed purposes. This information is compiled from Design plans only, unless otherwise stated, and therefore is subject to final survey and construction of operational works.

Disclosure Plan for Proposed Lot 80 on SP317659

Described as part of Lot 5007 on SP312157
 Existing Title Reference: 51216954

Locality of Collingwood Park (Ipswich City Council)

Level Datum: AHD der.
 Origin of Levels: PM203097
 RL of Origin: 45.557m
 Contour Interval: 0.25m

Scale @A3 1: 200
 Dwg No. 6777 S 37 DP C_80

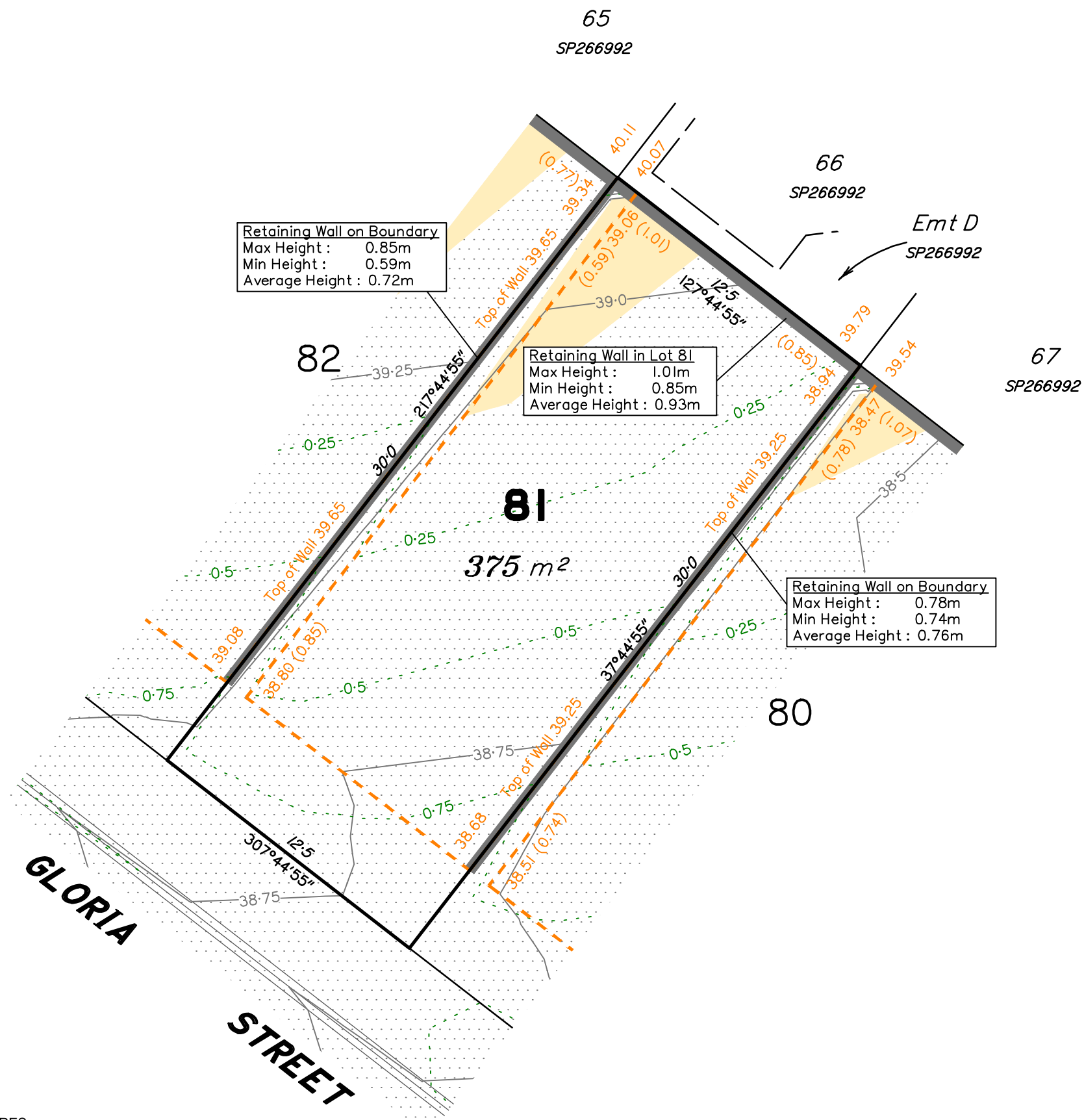
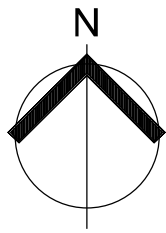

LEGEND

- Area of Cut
- Area of Fill
- Finished Surface Contours
- Depth of Fill Contours
- Retaining Wall (Height shown on lower side of wall)
- Proposed Earthworks Pad
- Finished Design Surface Level
- Future Lot Boundary

Not all items in this legend may be relevant to the lot shown on this plan.

NOTES

This plan has been prepared from preliminary survey plan (SP317659) and engineering data provided on the 23/09/2020 by Peak Urban Engineers.

Development approval has been received for this subdivision (application 2558/4/MAMC/C) from Ipswich City Council (13/06/2019).

Development approval has been granted for Operational Works for this lot.

All fill shall be placed and compacted in a controlled manner so that Level 1 level of responsibility may be achieved and certified as per AS3798-2007.

Issues	No.	by	Date	Description
A	TBG		25/06/20	Original Issue
B	TBG		20/07/20	Civil Design Update
C	TBG		24/09/20	Ret Wall Update

SCALE @ A3 1:200 - LENGTHS ARE IN METRES

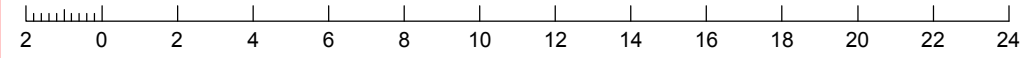

saunders havill group
 Saunders Havill Group Pty Ltd ABN 24 144 972 949
 Brisbane • Springfield • Rockhampton
 head office 9 Thompson St Bowen Hills Q 4006
 phone 1300 123 SHG web www.saundershavill.com
 • surveying • town planning • urban design • environmental management • landscape architecture

This Disclosure Plan is prepared for the sole purpose of satisfying the Disclosure requirements of the Land Sales Act and SHOULD NOT be used for any other purpose, particularly As-constructed purposes. This information is compiled from Design plans only, unless otherwise stated, and therefore is subject to final survey and construction of operational works.

Disclosure Plan for Proposed Lot 81 on SP317659
 Described as part of Lot 5007 on SP312157
 Existing Title Reference: 51216954
 Locality of Collingwood Park (Ipswich City Council)

Level Datum: AHD der.
 Origin of Levels: PM203097
 RL of Origin: 45.557m
 Contour Interval: 0.25m
 Scale @A3 1: 200
 Dwg No. 6777 S 37 DP C_81

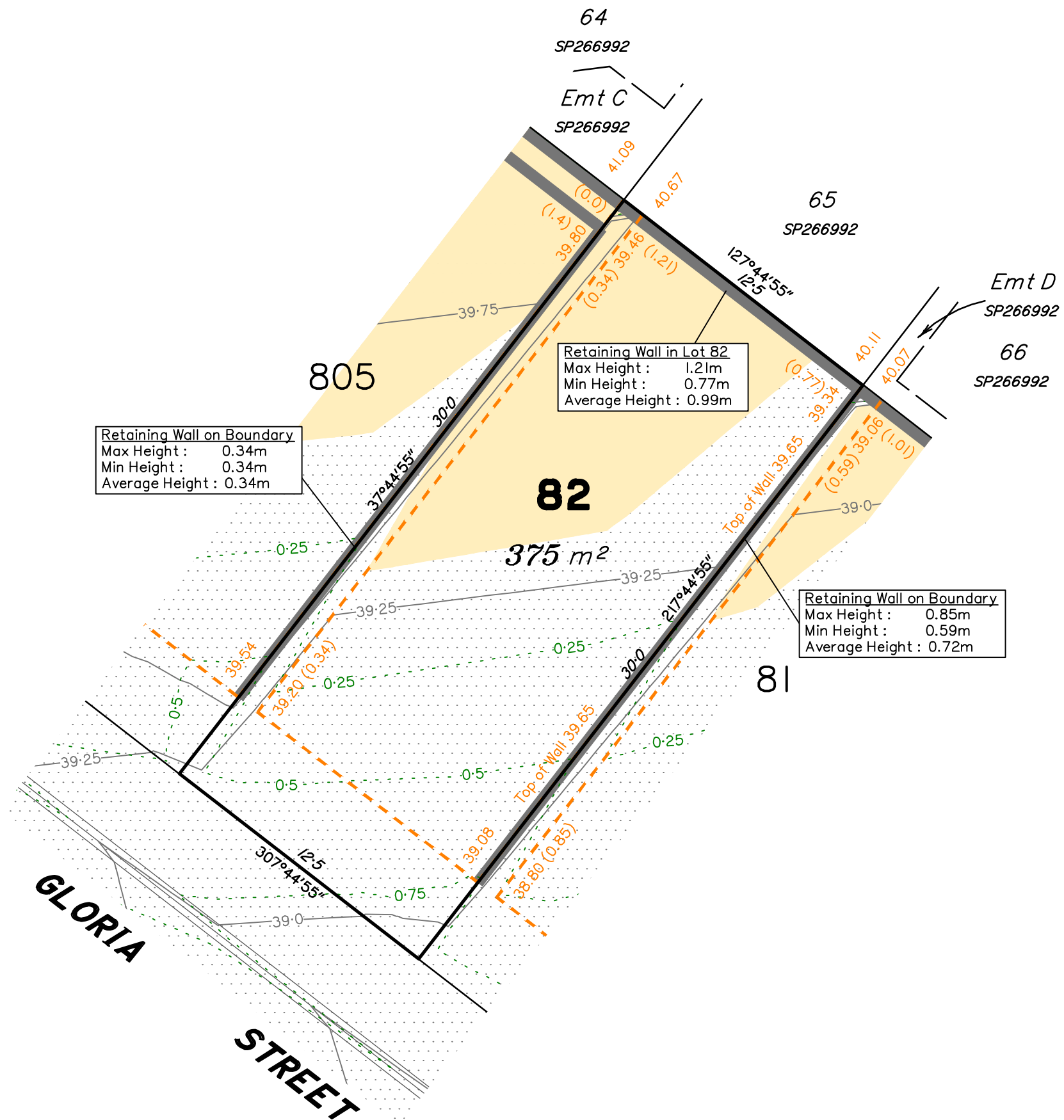
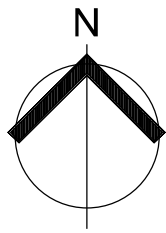

Retaining Wall on Boundary
 Max Height : 0.34m
 Min Height : 0.34m
 Average Height : 0.34m

Retaining Wall in Lot 82
 Max Height : 1.21m
 Min Height : 0.77m
 Average Height : 0.99m

Retaining Wall on Boundary
 Max Height : 0.85m
 Min Height : 0.59m
 Average Height : 0.72m

LEGEND

- Area of Cut
- Area of Fill
- Finished Surface Contours
- Depth of Fill Contours
- Retaining Wall (Height shown on lower side of wall)
- Proposed Earthworks Pad
- 38.78 Finished Design Surface Level
- Future Lot Boundary

Not all items in this legend may be relevant to the lot shown on this plan.

NOTES

This plan has been prepared from preliminary survey plan (SP317659) and engineering data provided on the 17/11/2020 by Peak Urban Engineers.

Development approval has been received for this subdivision (application 2558/4/MAMC/C) from Ipswich City Council (13/06/2019).

Development approval has been granted for Operational Works for this lot.

All fill shall be placed and compacted in a controlled manner so that Level 1 level of responsibility may be achieved and certified as per AS3798-2007.

Issues	No.	by	Date	Description
A	TBG		25/06/20	Original Issue
B	TBG		20/07/20	Civil Design Update
C	TBG		24/09/20	Ret Wall Update
D	TBG		18/11/20	Ret Wall in Lot 805 Update

SCALE @ A3 1:200 - LENGTHS ARE IN METRES

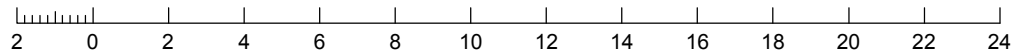

Saunders Havill Group Pty Ltd ABN 24 144 972 949
 Brisbane ● Springfield ● Rockhampton
 head office 9 Thompson St Bowen Hills Q 4006
 phone 1300 123 SHG web www.saundershavill.com

● surveying ● town planning ● urban design ● environmental management ● landscape architecture

This Disclosure Plan is prepared for the sole purpose of satisfying the Disclosure requirements of the Land Sales Act and SHOULD NOT be used for any other purpose, particularly As-constructed purposes. This information is compiled from Design plans only, unless otherwise stated, and therefore is subject to final survey and construction of operational works.

Disclosure Plan for Proposed Lot 82 on SP317659

Described as part of Lot 5007 on SP312157
 Existing Title Reference: 51216954

Locality of Collingwood Park (Ipswich City Council)

Level Datum: AHD der.
 Origin of Levels: PM203097
 RL of Origin: 45.557m
 Contour Interval: 0.25m

Scale @A3 1: 200
 Dwg No. 6777 S 37 DP D_82

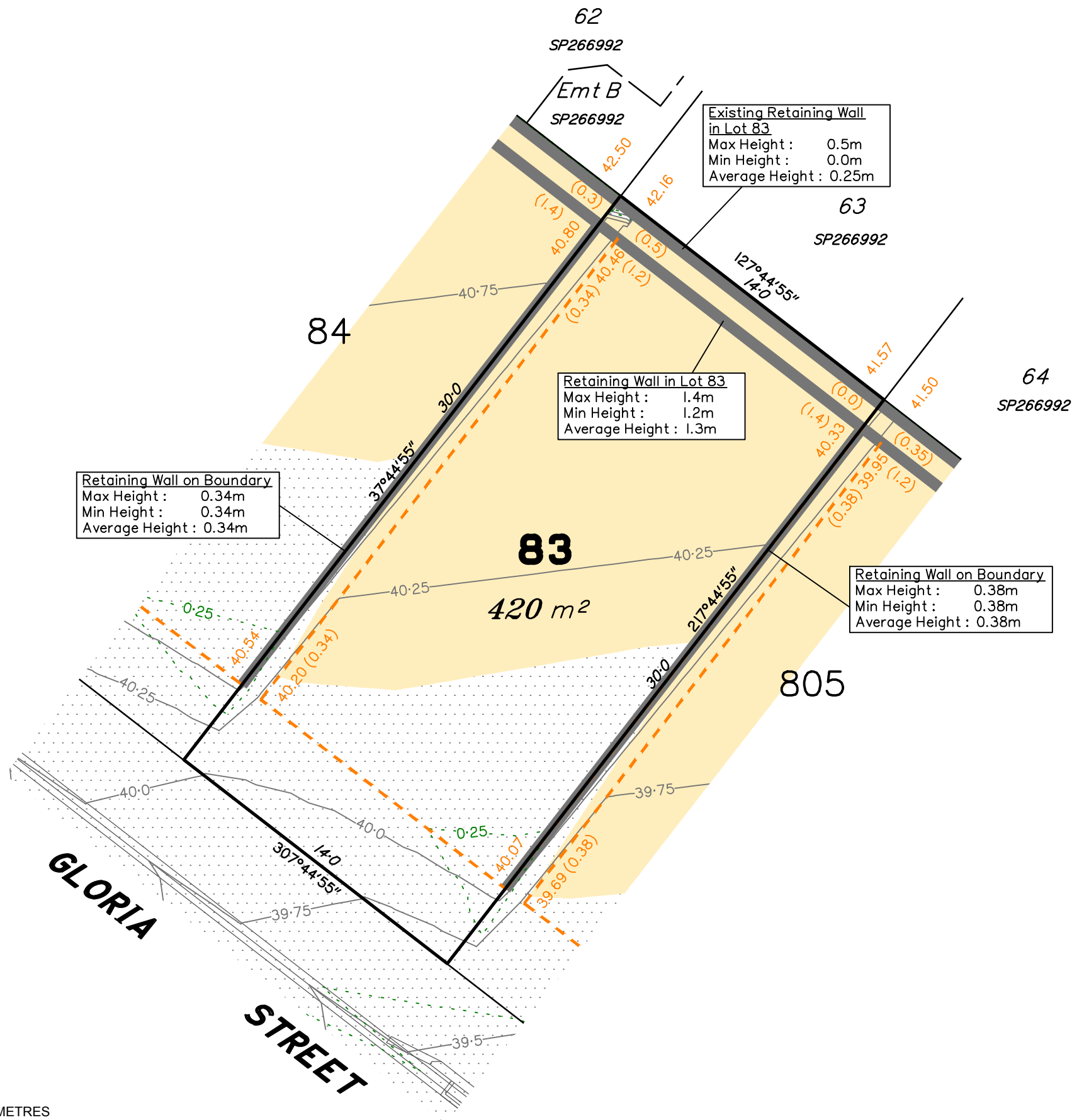
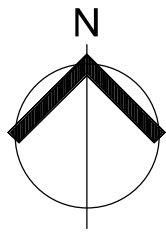

LEGEND

- Area of Cut
- Area of Fill
- Finished Surface Contours
- Depth of Fill Contours
- Retaining Wall (Height shown on lower side of wall)
- Proposed Earthworks Pad
- 38.78 Finished Design Surface Level
- Future Lot Boundary

Not all items in this legend may be relevant to the lot shown on this plan.

NOTES

This plan has been prepared from preliminary survey plan (SP317659) and engineering data provided on the 17/11/2020 by Peak Urban Engineers.

Development approval has been received for this subdivision (application 2558/4/MAMC/C) from Ipswich City Council (13/06/2019).

Development approval has been granted for Operational Works for this lot.

All fill shall be placed and compacted in a controlled manner so that Level 1 level of responsibility may be achieved and certified as per AS3798-2007.

Issues	No.	by	Date	Description
A	TBG		25/06/20	Original Issue
B	TBG		20/07/20	Civil Design Update
C	TBG		18/11/20	Ret Wall Update

SCALE @ A3 1:200 - LENGTHS ARE IN METRES

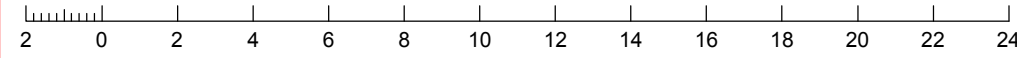

SH saunders havill group
 Saunders Havill Group Pty Ltd ABN 24 144 972 949
 Brisbane • Springfield • Rockhampton
 head office 9 Thompson St Bowen Hills Q 4006
 phone 1300 123 5HG web www.saundershavill.com
 • surveying • town planning • urban design • environmental management • landscape architecture

This Disclosure Plan is prepared for the sole purpose of satisfying the Disclosure requirements of the Land Sales Act and SHOULD NOT be used for any other purpose, particularly As-constructed purposes. This information is compiled from Design plans only, unless otherwise stated, and therefore is subject to final survey and construction of operational works.

Disclosure Plan for Proposed Lot 83 on SP317659
 Described as part of Lot 5007 on SP312157
 Existing Title Reference: 51216954
 Locality of Collingwood Park (Ipswich City Council)

Level Datum: AHD der.
 Origin of Levels: PM203097
 RL of Origin: 45.557m
 Contour Interval: 0.25m
 Scale @A3 1: 200
 Dwg No. 6777 S 37 DP C_83

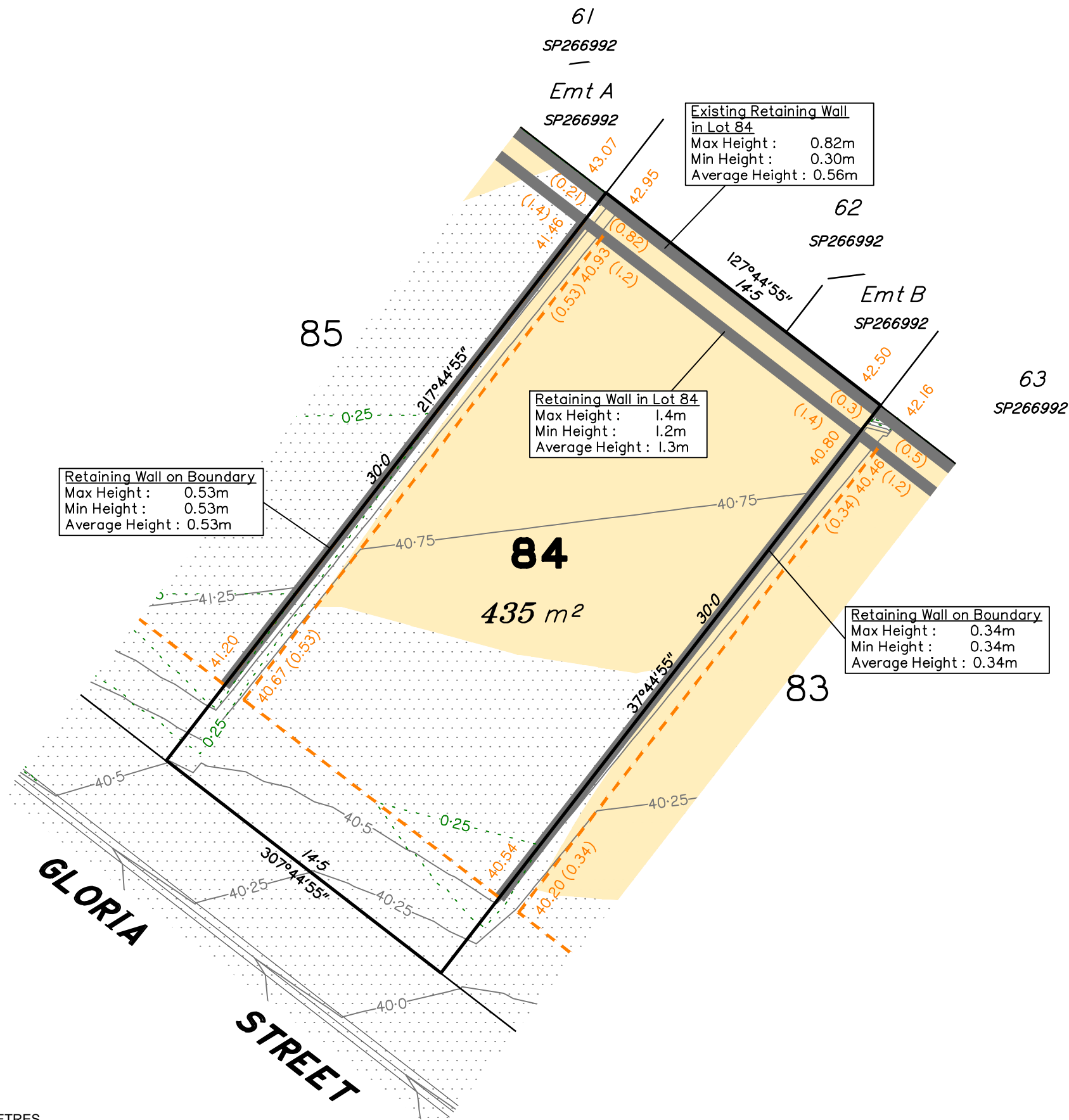

LEGEND

- Area of Cut
- Area of Fill
- Finished Surface Contours
- Depth of Fill Contours
- Retaining Wall (Height shown on lower side of wall)
- Proposed Earthworks Pad
- 38.78 Finished Design Surface Level
- Future Lot Boundary

Not all items in this legend may be relevant to the lot shown on this plan.

NOTES

This plan has been prepared from preliminary survey plan (SP317659) and engineering data provided on the 17/11/2020 by Peak Urban Engineers.

Development approval has been received for this subdivision (application 2558/4/MAMC/C) from Ipswich City Council (13/06/2019).

Development approval has been granted for Operational Works for this lot.

All fill shall be placed and compacted in a controlled manner so that Level 1 level of responsibility may be achieved and certified as per AS3798-2007.

Issues	No.	by	Date	Description
A	TBG		25/06/20	Original Issue
B	TBG		20/07/20	Civil Design Update
C	TBG		18/11/20	Ret Wall Update

SCALE @ A3 1:200 - LENGTHS ARE IN METRES

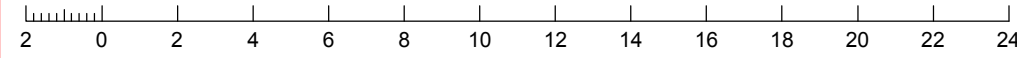

SH saunders havill group
 Saunders Havill Group Pty Ltd ABN 24 144 972 949
 Brisbane • Springfield • Rockhampton
 head office 9 Thompson St Bowen Hills Q 4006
 phone 1300 123 5HG web www.saundershavill.com
 • surveying • town planning • urban design • environmental management • landscape architecture

This Disclosure Plan is prepared for the sole purpose of satisfying the Disclosure requirements of the Land Sales Act and SHOULD NOT be used for any other purpose, particularly As-constructed purposes. This information is compiled from Design plans only, unless otherwise stated, and therefore is subject to final survey and construction of operational works.

Disclosure Plan for Proposed Lot 84 on SP317659
 Described as part of Lot 5007 on SP312157
 Existing Title Reference: 51216954
 Locality of Collingwood Park (Ipswich City Council)

Level Datum: AHD der.
 Origin of Levels: PM203097
 RL of Origin: 45.557m
 Contour Interval: 0.25m
 Scale @A3 1: 200
 Dwg No. 6777 S 37 DP C_84

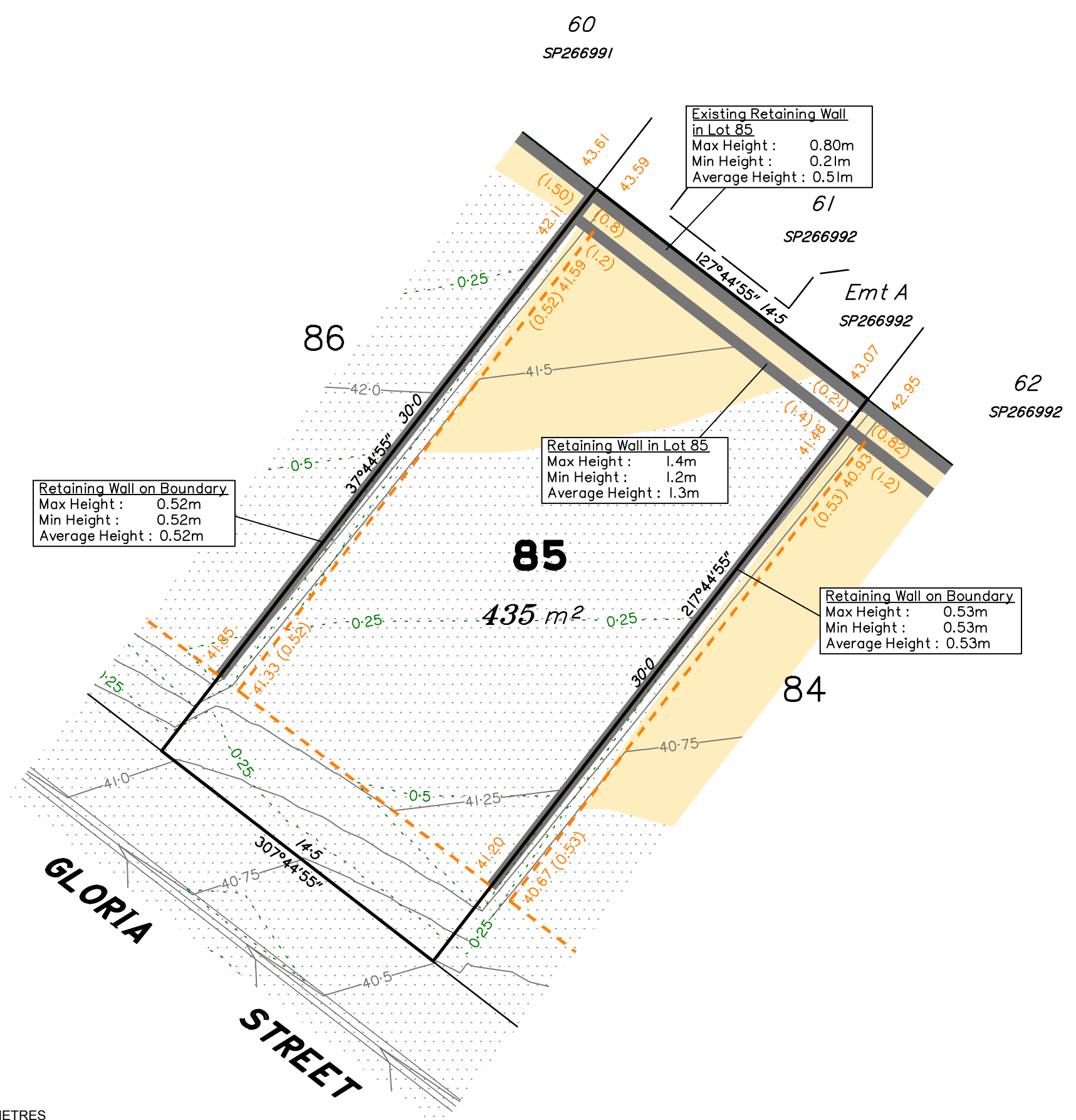
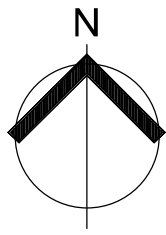

LEGEND

- Area of Cut
- Area of Fill
- Finished Surface Contours
- Depth of Fill Contours
- Retaining Wall (Height shown on lower side of wall)
- Proposed Earthworks Pad
- 38.78 Finished Design Surface Level
- Future Lot Boundary

Not all items in this legend may be relevant to the lot shown on this plan.

NOTES

This plan has been prepared from preliminary survey plan (SP317659) and engineering data provided on the 17/11/2020 by Peak Urban Engineers.

Development approval has been received for this subdivision (application 2558/4/MAMC/C) from Ipswich City Council (13/06/2019).

Development approval has been granted for Operational Works for this lot.

All fill shall be placed and compacted in a controlled manner so that Level 1 level of responsibility may be achieved and certified as per AS3798-2007.

Issues	No.	by	Date	Description
A	TBG		25/06/20	Original Issue
B	TBG		20/07/20	Civil Design Update
C	TBG		18/11/20	Ret Wall Update

SCALE @ A3 1:200 - LENGTHS ARE IN METRES

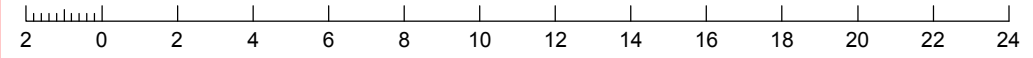

Saunders Havill Group Pty Ltd ABN 24 144 972 949
 Brisbane • Springfield • Rockhampton
 head office 9 Thompson St Bowen Hills Q 4006
 phone 1300 123 SHG web www.saundershavill.com
 • surveying • town planning • urban design • environmental management • landscape architecture

This Disclosure Plan is prepared for the sole purpose of satisfying the Disclosure requirements of the Land Sales Act and SHOULD NOT be used for any other purpose, particularly As-constructed purposes. This information is compiled from Design plans only, unless otherwise stated, and therefore is subject to final survey and construction of operational works.

Disclosure Plan for Proposed Lot 85 on SP317659
 Described as part of Lot 5007 on SP312157
 Existing Title Reference: 51216954
 Locality of Collingwood Park (Ipswich City Council)

Level Datum: AHD der.
 Origin of Levels: PM203097
 RL of Origin: 45.557m
 Contour Interval: 0.25m
 Scale @A3 1: 200
 Dwg No. 6777 S 37 DP C_85

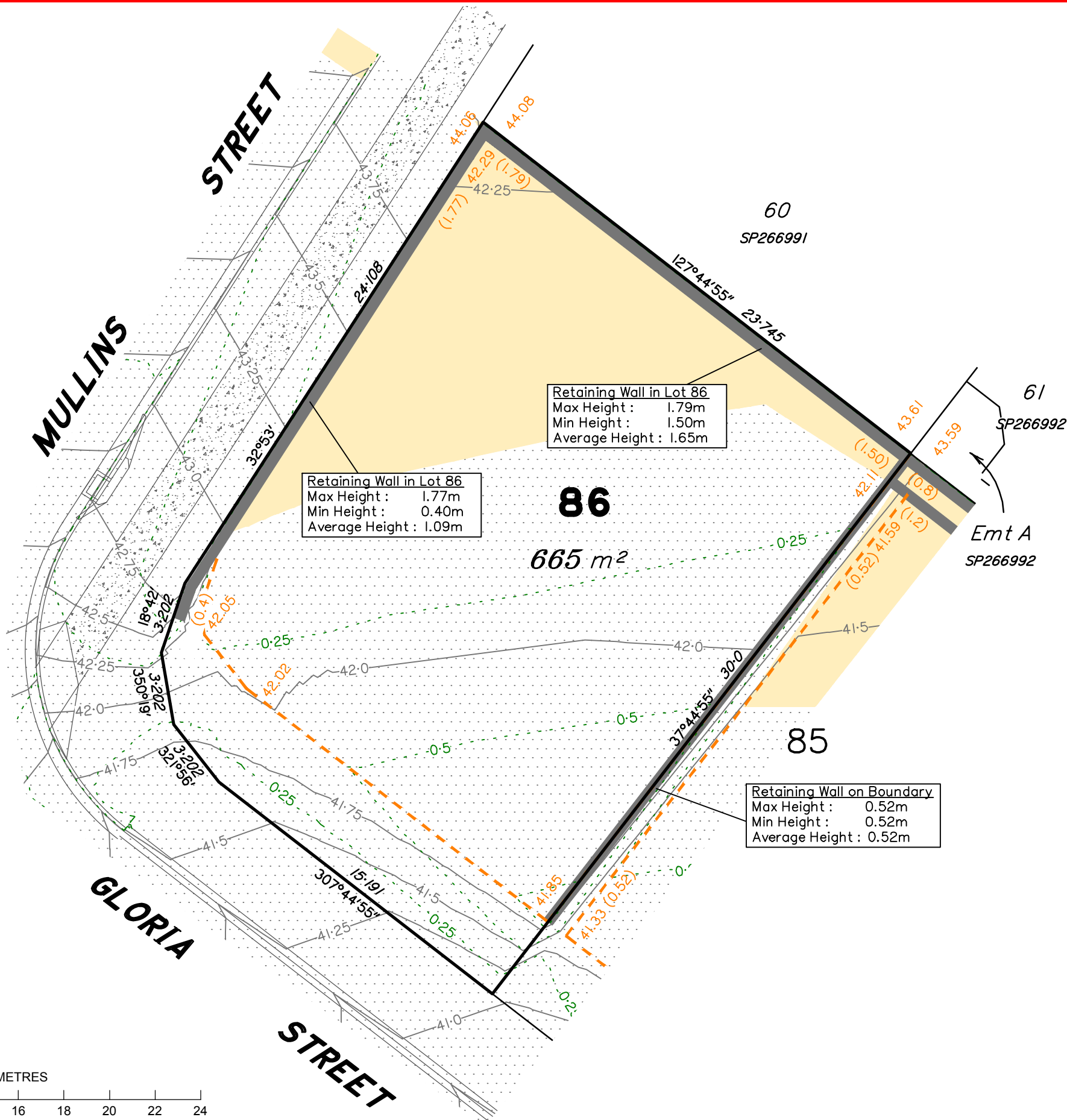
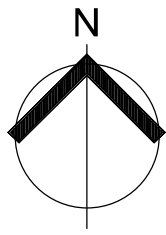

LEGEND

- Area of Cut
- Area of Fill
- Finished Surface Contours
- Depth of Fill Contours
- Retaining Wall
(Height shown on lower side of wall)
- Proposed Earthworks Pad
- 38.78 Finished Design Surface Level
- Future Lot Boundary

Not all items in this legend may be relevant to the lot shown on this plan.

NOTES

This plan has been prepared from preliminary survey plan (SP317659) and engineering data provided on the 09/07/2020 by Peak Urban Engineers.

Development approval has been received for this subdivision (application 2558/4/MAMC/C) from Ipswich City Council (13/06/2019).

Development approval has been granted for Operational Works for this lot.

All fill shall be placed and compacted in a controlled manner so that Level 1 level of responsibility may be achieved and certified as per AS3798-2007.

SCALE @ A3 1:200 - LENGTHS ARE IN METRES

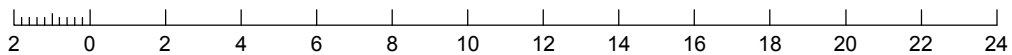

Saunders Havill Group Pty Ltd ABN 24 144 972 949
 Brisbane ● Springfield ● Rockhampton
 head office 9 Thompson St Bowen Hills Q 4006
 phone 1300 123 SHG web www.saundershavill.com

● surveying ● town planning ● urban design ● environmental management ● landscape architecture

This Disclosure Plan is prepared for the sole purpose of satisfying the Disclosure requirements of the Land Sales Act and SHOULD NOT be used for any other purpose, particularly As-constructed purposes. This information is compiled from Design plans only, unless otherwise stated, and therefore is subject to final survey and construction of operational works.

Disclosure Plan for Proposed Lot 86 on SP317659

Described as part of Lot 5007 on SP312157
 Existing Title Reference: 51216954

Locality of Collingwood Park (Ipswich City Council)

Level Datum: AHD der.
 Origin of Levels: PM203097
 RL of Origin: 45.557m
 Contour Interval: 0.25m

Scale @A3 1: 200
 Dwg No. 6777 S 37 DP B_86

No.	by	Date	Description
A	TBG	25/06/20	Original Issue
B	TBG	20/07/20	Civil Design Update

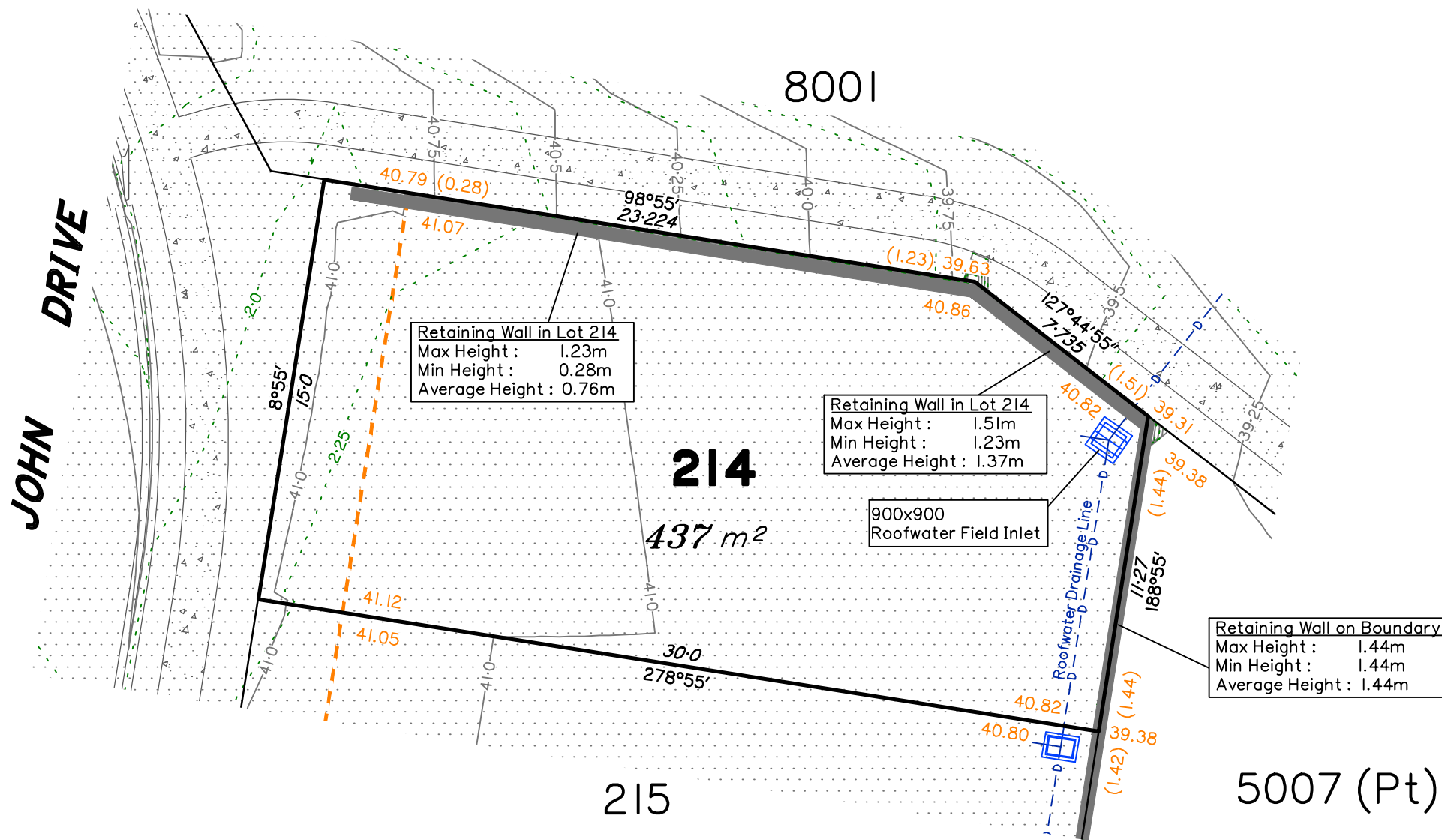
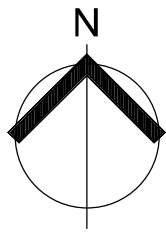

Retaining Wall in Lot 214
 Max Height : 1.23m
 Min Height : 0.28m
 Average Height : 0.76m

Retaining Wall in Lot 214
 Max Height : 1.51m
 Min Height : 1.23m
 Average Height : 1.37m

900x900
 Roofwater Field Inlet

Retaining Wall on Boundary
 Max Height : 1.44m
 Min Height : 1.44m
 Average Height : 1.44m

SCALE @ A3 1:200 - LENGTHS ARE IN METRES

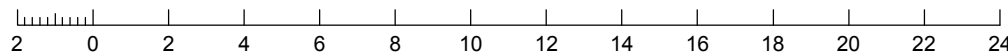

LEGEND

- Area of Cut
- Area of Fill
- Finished Surface Contours
- Depth of Fill Contours
- Retaining Wall
(Height shown on lower side of wall)
- Proposed Earthworks Pad
- 38.78 Finished Design Surface Level
- Future Lot Boundary

Not all items in this legend may be relevant to the lot shown on this plan.

NOTES

This plan has been prepared from preliminary survey plan (SP317659) and engineering data provided on the 10/09/2020 by Peak Urban Engineers.

Development approval has been received for this subdivision (application 2558/4/MAMC/C) from Ipswich City Council (13/06/2019).

Development approval has been granted for Operational Works for this lot.

All fill shall be placed and compacted in a controlled manner so that Level 1 level of responsibility may be achieved and certified as per AS3798-2007.

Issues	No.	by	Date	Description
	A	TBG	25/06/20	Original Issue
	B	TBG	10/09/20	Earthworks & Roofwater Update



Saunders Havill Group Pty Ltd ABN 24 144 972 949
 Brisbane • Springfield • Rockhampton
 head office 9 Thompson St Bowen Hills Q 4006
 phone 1300 123 5HG web www.saundershavill.com

• surveying • town planning • urban design • environmental management • landscape architecture

This Disclosure Plan is prepared for the sole purpose of satisfying the Disclosure requirements of the Land Sales Act and SHOULD NOT be used for any other purpose, particularly As-constructed purposes. This information is compiled from Design plans only, unless otherwise stated, and therefore is subject to final survey and construction of operational works.

Disclosure Plan for Proposed Lot 214 on SP317659

Described as part of Lot 5007 on SP312157
 Existing Title Reference: 51216954

Locality of Collingwood Park (Ipswich City Council)

Level Datum: AHD der.
 Origin of Levels: PM203097
 RL of Origin: 45.557m
 Contour Interval: 0.25m

Scale @A3 1: 200
 Dwg No. 6777 S 37 DP B_214

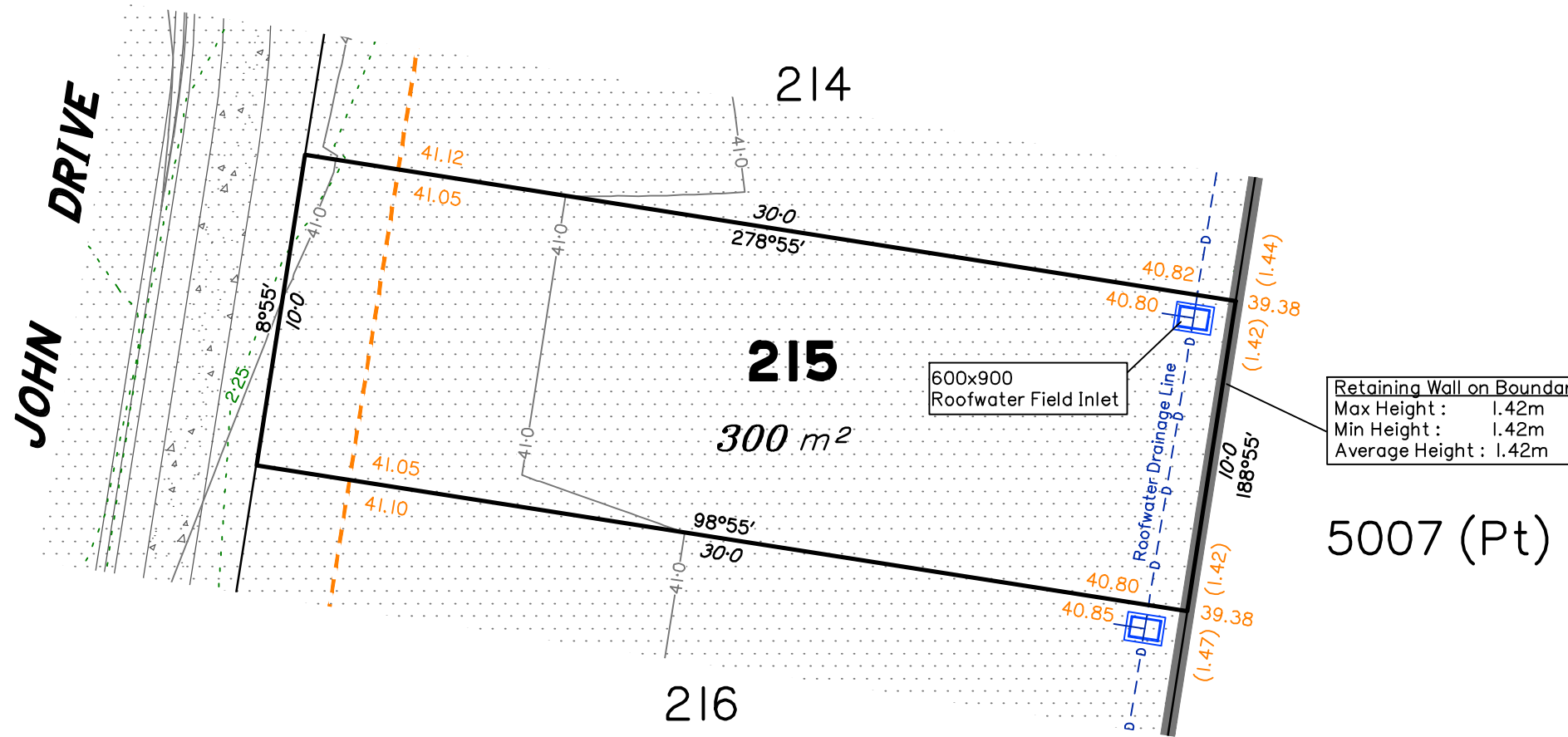

SCALE @ A3 1:200 - LENGTHS ARE IN METRES

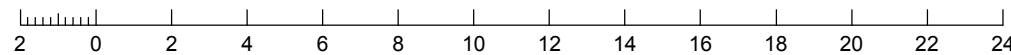

LEGEND

- Area of Cut
- Area of Fill
- Finished Surface Contours
- Depth of Fill Contours
- Retaining Wall
(Height shown on lower side of wall)
- Proposed Earthworks Pad
- 38.78 Finished Design Surface Level
- Future Lot Boundary

Not all items in this legend may be relevant to the lot shown on this plan.

NOTES

This plan has been prepared from preliminary survey plan (SP317659) and engineering data provided on the 10/09/2020 by Peak Urban Engineers.

Development approval has been received for this subdivision (application 2558/4/MAMC/C) from Ipswich City Council (13/06/2019).

Development approval has been granted for Operational Works for this lot.

All fill shall be placed and compacted in a controlled manner so that Level 1 level of responsibility may be achieved and certified as per AS3798-2007.

Issues	No.	by	Date	Description
A	TBG		25/06/20	Original Issue
B	TBG		10/09/20	Earthworks & Roofwater Update



Saunders Havill Group Pty Ltd ABN 24 144 972 949
 Brisbane ● Springfield ● Rockhampton
 head office 9 Thompson St Bowen Hills Q 4006
 phone 1300 123 5HG web www.saundershavill.com

● surveying ● town planning ● urban design ● environmental management ● landscape architecture

This Disclosure Plan is prepared for the sole purpose of satisfying the Disclosure requirements of the Land Sales Act and SHOULD NOT be used for any other purpose, particularly As-constructed purposes. This information is compiled from Design plans only, unless otherwise stated, and therefore is subject to final survey and construction of operational works.

Disclosure Plan for Proposed Lot 215 on SP317659

Described as part of Lot 5007 on SP312157
 Existing Title Reference: 51216954

Locality of Collingwood Park (Ipswich City Council)

Level Datum: AHD der.
 Origin of Levels: PM203097
 RL of Origin: 45.557m
 Contour Interval: 0.25m

Scale @A3 1: 200
 Dwg No. 6777 S 37 DP B_215

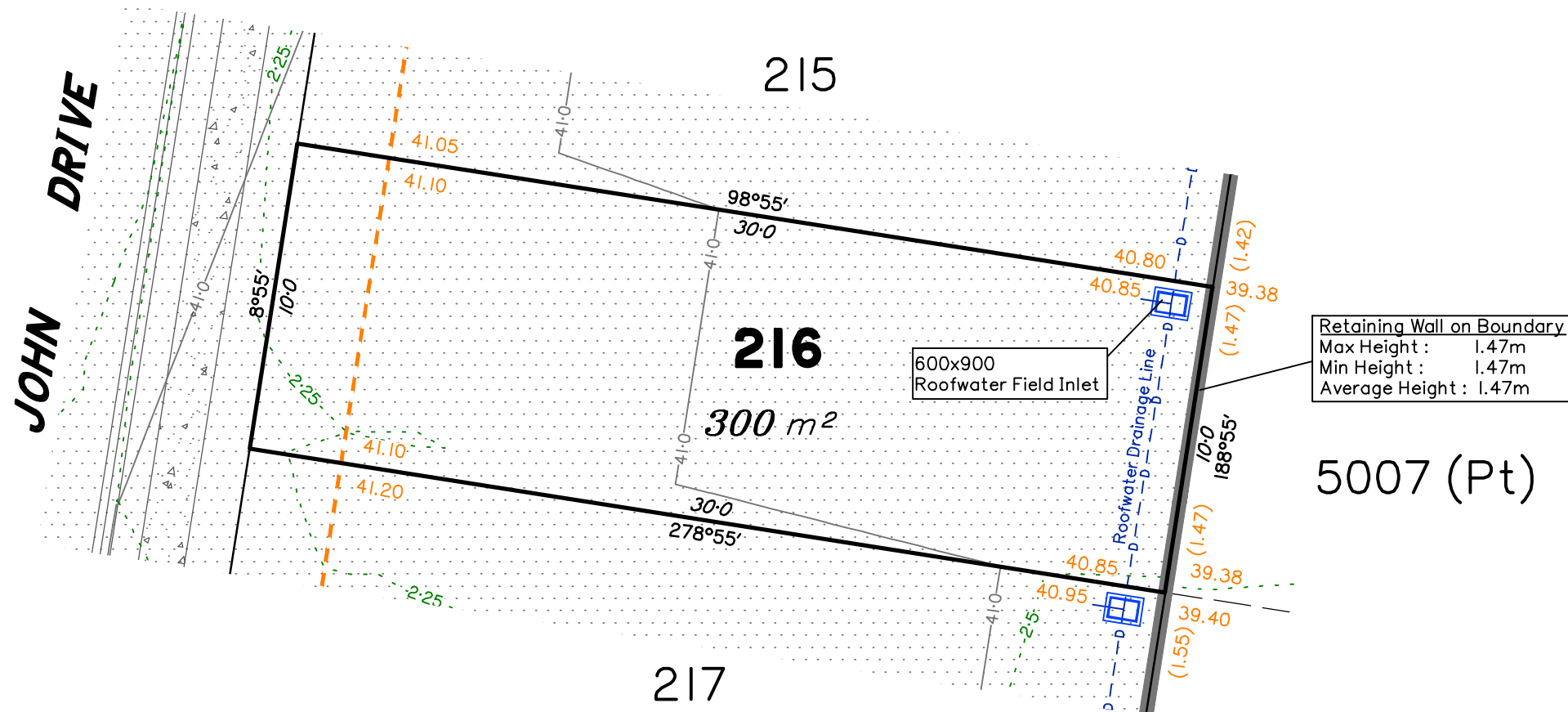
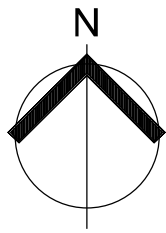

Retaining Wall on Boundary
 Max Height : 1.47m
 Min Height : 1.47m
 Average Height : 1.47m

LEGEND

- Area of Cut
- Area of Fill
- Finished Surface Contours
- Depth of Fill Contours
- Retaining Wall
(Height shown on lower side of wall)
- Proposed Earthworks Pad
- 38.78 Finished Design Surface Level
- Future Lot Boundary

Not all items in this legend may be relevant to the lot shown on this plan.

NOTES

This plan has been prepared from preliminary survey plan (SP317659) and engineering data provided on the 10/09/2020 by Peak Urban Engineers.

Development approval has been received for this subdivision (application 2558/4/MAMC/C) from Ipswich City Council (13/06/2019).

Development approval has been granted for Operational Works for this lot.

All fill shall be placed and compacted in a controlled manner so that Level 1 level of responsibility may be achieved and certified as per AS3798-2007.

SCALE @ A3 1:200 - LENGTHS ARE IN METRES

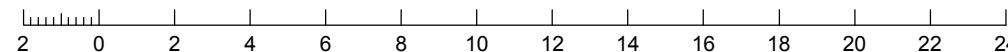

Issues	No.	by	Date	Description
A	TBG		25/06/20	Original Issue
B	TBG		10/09/20	Earthworks & Roofwater Update



Saunders Havill Group Pty Ltd ABN 24 144 972 949
 Brisbane ● Springfield ● Rockhampton
 head office 9 Thompson St Bowen Hills Q 4006
 phone 1300 123 5HG web www.saundershavill.com

● surveying ● town planning ● urban design ● environmental management ● landscape architecture

This Disclosure Plan is prepared for the sole purpose of satisfying the Disclosure requirements of the Land Sales Act and SHOULD NOT be used for any other purpose, particularly As-constructed purposes. This information is compiled from Design plans only, unless otherwise stated, and therefore is subject to final survey and construction of operational works.

Disclosure Plan for Proposed Lot 216 on SP317659

Described as part of Lot 5007 on SP312157
 Existing Title Reference: 51216954

Locality of Collingwood Park (Ipswich City Council)

Level Datum: AHD der.
 Origin of Levels: PM203097
 RL of Origin: 45.557m
 Contour Interval: 0.25m

Scale @A3 1: 200
 Dwg No. 6777 S 37 DP B_216

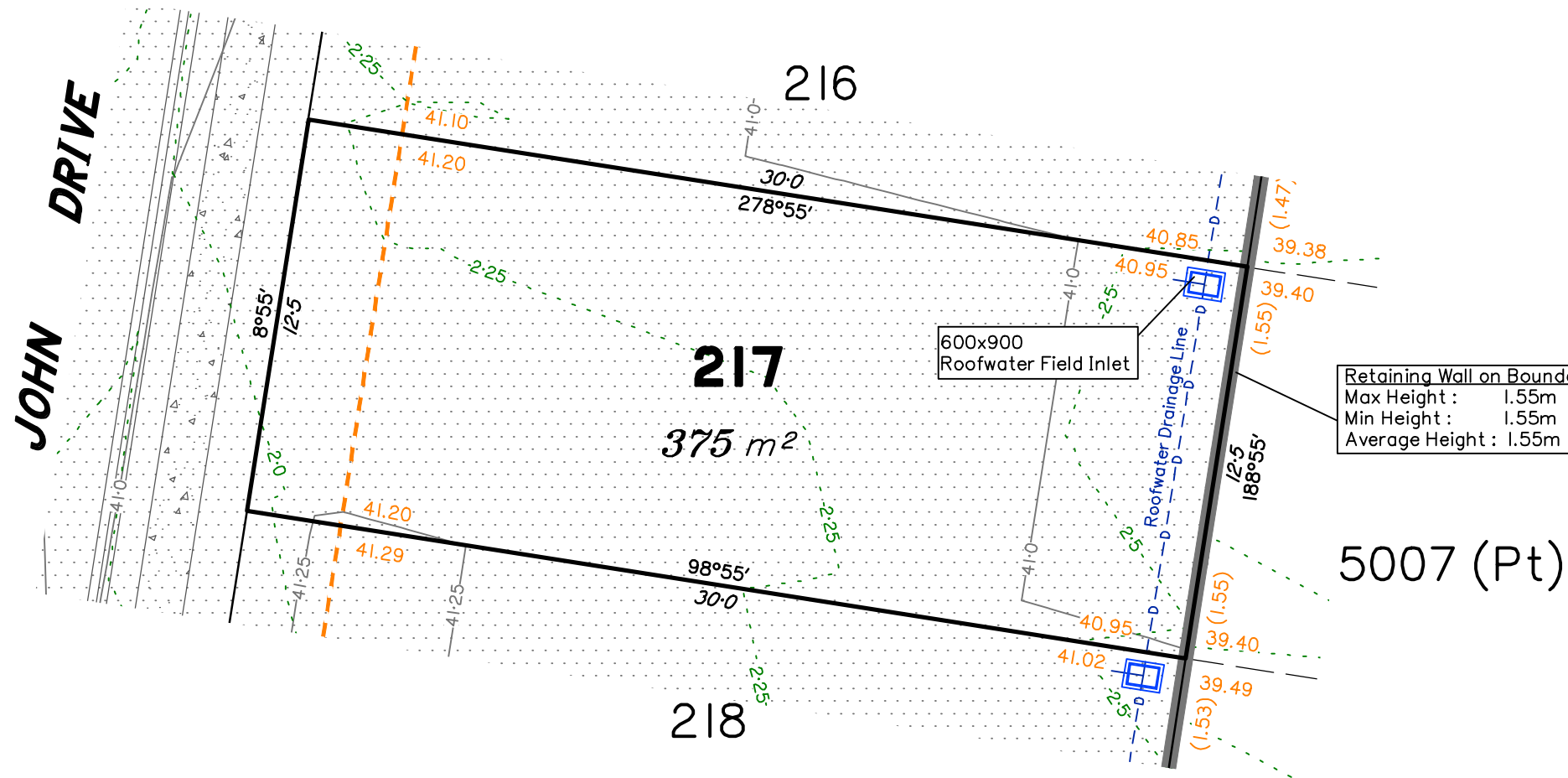
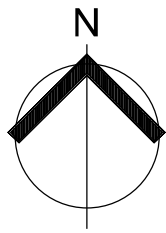

SCALE @ A3 1:200 - LENGTHS ARE IN METRES

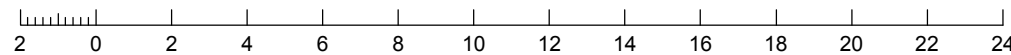

LEGEND

- Area of Cut
- Area of Fill
- Finished Surface Contours
- Depth of Fill Contours
- Retaining Wall
(Height shown on lower side of wall)
- Proposed Earthworks Pad
- 38.78 Finished Design Surface Level
- Future Lot Boundary

Not all items in this legend may be relevant to the lot shown on this plan.

NOTES

This plan has been prepared from preliminary survey plan (SP317659) and engineering data provided on the 10/09/2020 by Peak Urban Engineers.

Development approval has been received for this subdivision (application 2558/4/MAMC/C) from Ipswich City Council (13/06/2019).

Development approval has been granted for Operational Works for this lot.

All fill shall be placed and compacted in a controlled manner so that Level 1 level of responsibility may be achieved and certified as per AS3798-2007.

Issues	No.	by	Date	Description
A	TBG		25/06/20	Original Issue
B	TBG		10/09/20	Earthworks & Roofwater Update



Saunders Havill Group Pty Ltd ABN 24 144 972 949
 Brisbane ● Springfield ● Rockhampton
 head office 9 Thompson St Bowen Hills Q 4006
 phone 1300 123 5HG web www.saundershavill.com

● surveying ● town planning ● urban design ● environmental management ● landscape architecture

This Disclosure Plan is prepared for the sole purpose of satisfying the Disclosure requirements of the Land Sales Act and SHOULD NOT be used for any other purpose, particularly As-constructed purposes. This information is compiled from Design plans only, unless otherwise stated, and therefore is subject to final survey and construction of operational works.

Disclosure Plan for Proposed Lot 217 on SP317659

Described as part of Lot 5007 on SP312157
 Existing Title Reference: 51216954

Locality of Collingwood Park (Ipswich City Council)

Level Datum: AHD der.
 Origin of Levels: PM203097
 RL of Origin: 45.557m
 Contour Interval: 0.25m

Scale @A3 1: 200
 Dwg No. 6777 S 37 DP B_217

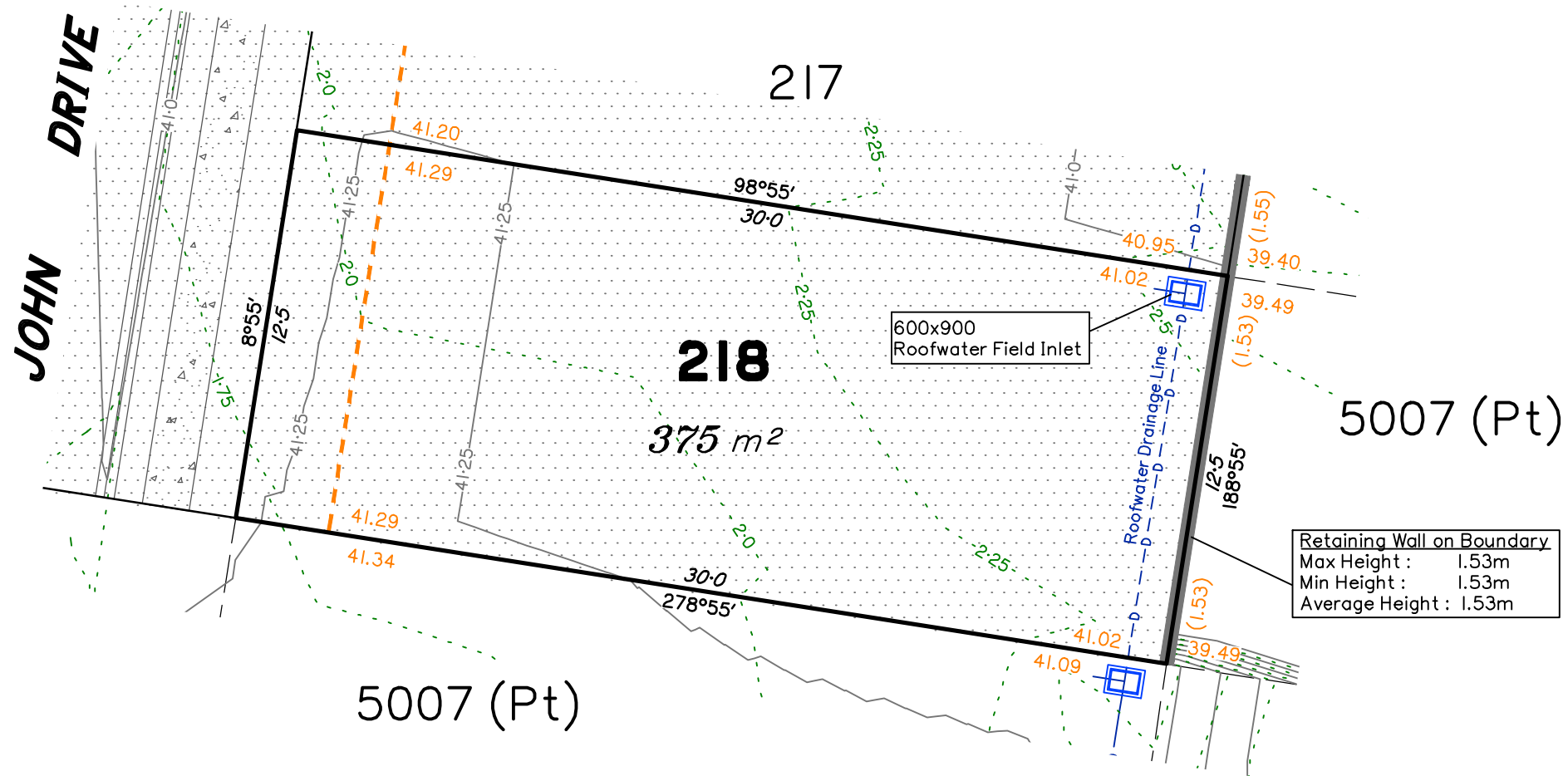
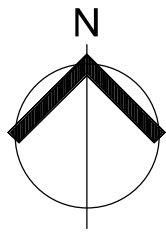

LEGEND

- Area of Cut
- Area of Fill
- Finished Surface Contours
- - - - - Depth of Fill Contours
- Retaining Wall
(Height shown on lower side of wall)
- Proposed Earthworks Pad
- Finished Design Surface Level
- Future Lot Boundary

Not all items in this legend may be relevant to the lot shown on this plan.

NOTES

This plan has been prepared from preliminary survey plan (SP317659) and engineering data provided on the 10/09/2020 by Peak Urban Engineers.

Development approval has been received for this subdivision (application 2558/4/MAMC/C) from Ipswich City Council (13/06/2019).

Development approval has been granted for Operational Works for this lot.

All fill shall be placed and compacted in a controlled manner so that Level 1 level of responsibility may be achieved and certified as per AS3798-2007.

SCALE @ A3 1:200 - LENGTHS ARE IN METRES

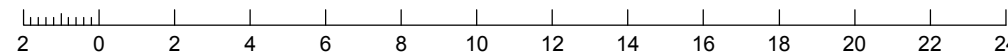

No.	by	Date	Description
A	TBG	25/06/20	Original Issue
B	TBG	10/09/20	Earthworks & Roofwater Update



Saunders Havill Group Pty Ltd ABN 24 144 972 949
 Brisbane ● Springfield ● Rockhampton
 head office 9 Thompson St Bowen Hills Q 4006
 phone 1300 123 5HG web www.saundershavill.com

● surveying ● town planning ● urban design ● environmental management ● landscape architecture

This Disclosure Plan is prepared for the sole purpose of satisfying the Disclosure requirements of the Land Sales Act and SHOULD NOT be used for any other purpose, particularly As-constructed purposes. This information is compiled from Design plans only, unless otherwise stated, and therefore is subject to final survey and construction of operational works.

Disclosure Plan for Proposed Lot 218 on SP317659

Described as part of Lot 5007 on SP312157
 Existing Title Reference: 51216954

Locality of Collingwood Park (Ipswich City Council)

Level Datum: AHD der.
 Origin of Levels: PM203097
 RL of Origin: 45.557m
 Contour Interval: 0.25m

Scale @A3 1: 200
 Dwg No. 6777 S 37 DP B_218

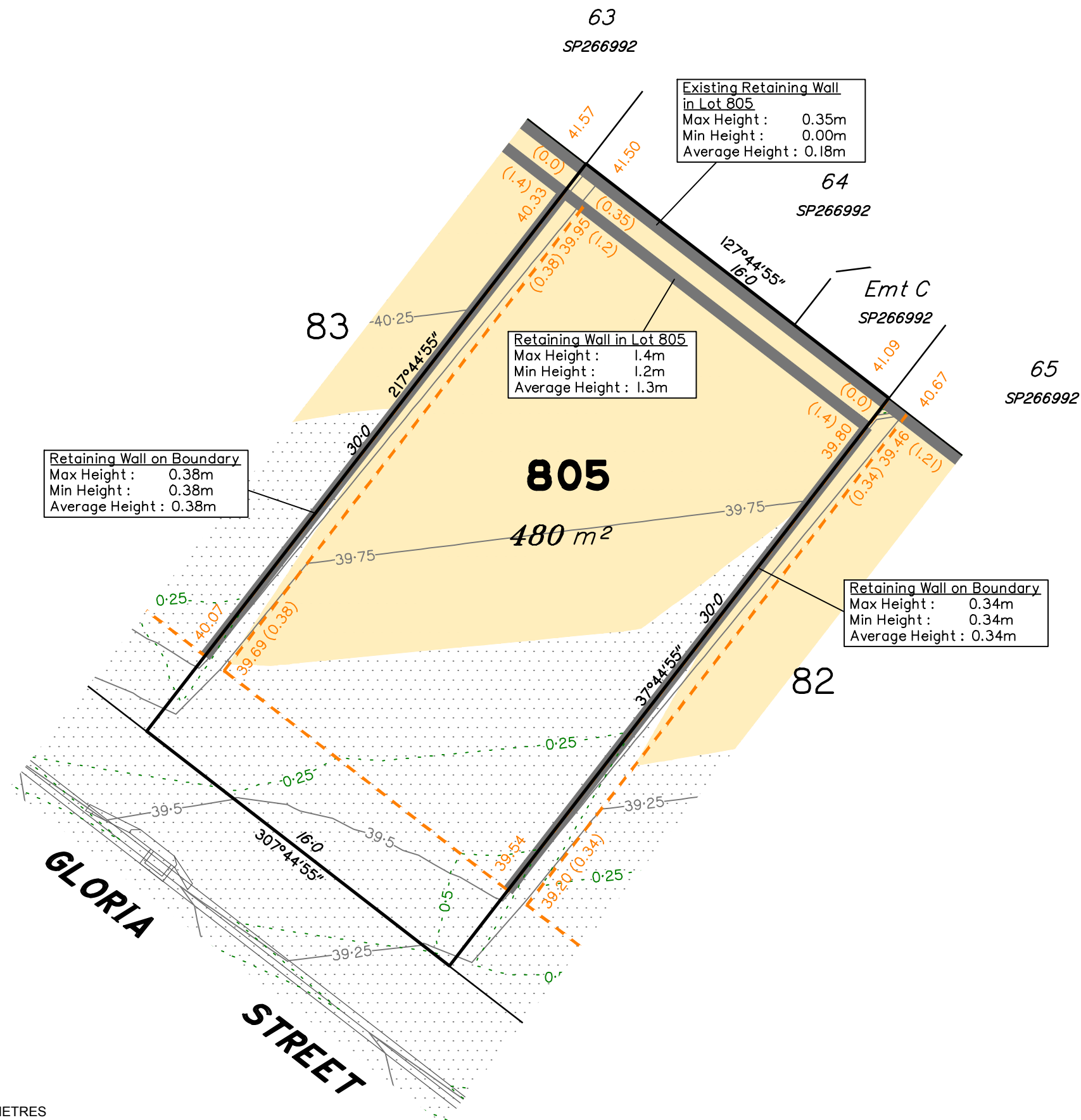

LEGEND

- Area of Cut
- Area of Fill
- Finished Surface Contours
- Depth of Fill Contours
- Retaining Wall
(Height shown on lower side of wall)
- Proposed Earthworks Pad
- 38.78 Finished Design Surface Level
- Future Lot Boundary

Not all items in this legend may be relevant to the lot shown on this plan.

NOTES

This plan has been prepared from preliminary survey plan (SP317659) and engineering data provided on the 17/11/2020 by Peak Urban Engineers.

Development approval has been received for this subdivision (application 2558/4/MAMC/C) from Ipswich City Council (13/06/2019).

Development approval has been granted for Operational Works for this lot.

All fill shall be placed and compacted in a controlled manner so that Level 1 level of responsibility may be achieved and certified as per AS3798-2007.

Issues	No.	by	Date	Description
A	TBG		25/06/20	Original Issue
B	TBG		20/07/20	Civil Design Update
C	TBG		18/11/20	Ret Wall Update

SCALE @ A3 1:200 - LENGTHS ARE IN METRES

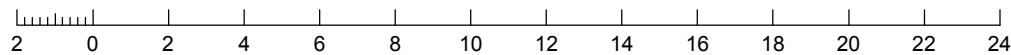

Saunders Havill Group Pty Ltd ABN 24 144 972 949
 Brisbane ● Springfield ● Rockhampton
 head office 9 Thompson St Bowen Hills Q 4006
 phone 1300 123 SHG web www.saundershavill.com

● surveying ● town planning ● urban design ● environmental management ● landscape architecture

This Disclosure Plan is prepared for the sole purpose of satisfying the Disclosure requirements of the Land Sales Act and SHOULD NOT be used for any other purpose, particularly As-constructed purposes. This information is compiled from Design plans only, unless otherwise stated, and therefore is subject to final survey and construction of operational works.

Disclosure Plan for Proposed Lot 805 on SP317659

Described as part of Lot 5007 on SP312157
 Existing Title Reference: 51216954

Locality of Collingwood Park (Ipswich City Council)

Level Datum: AHD der.
 Origin of Levels: PM203097
 RL of Origin: 45.557m
 Contour Interval: 0.25m

Scale @A3 1: 200
 Dwg No. 6777 S 37 DP C_805

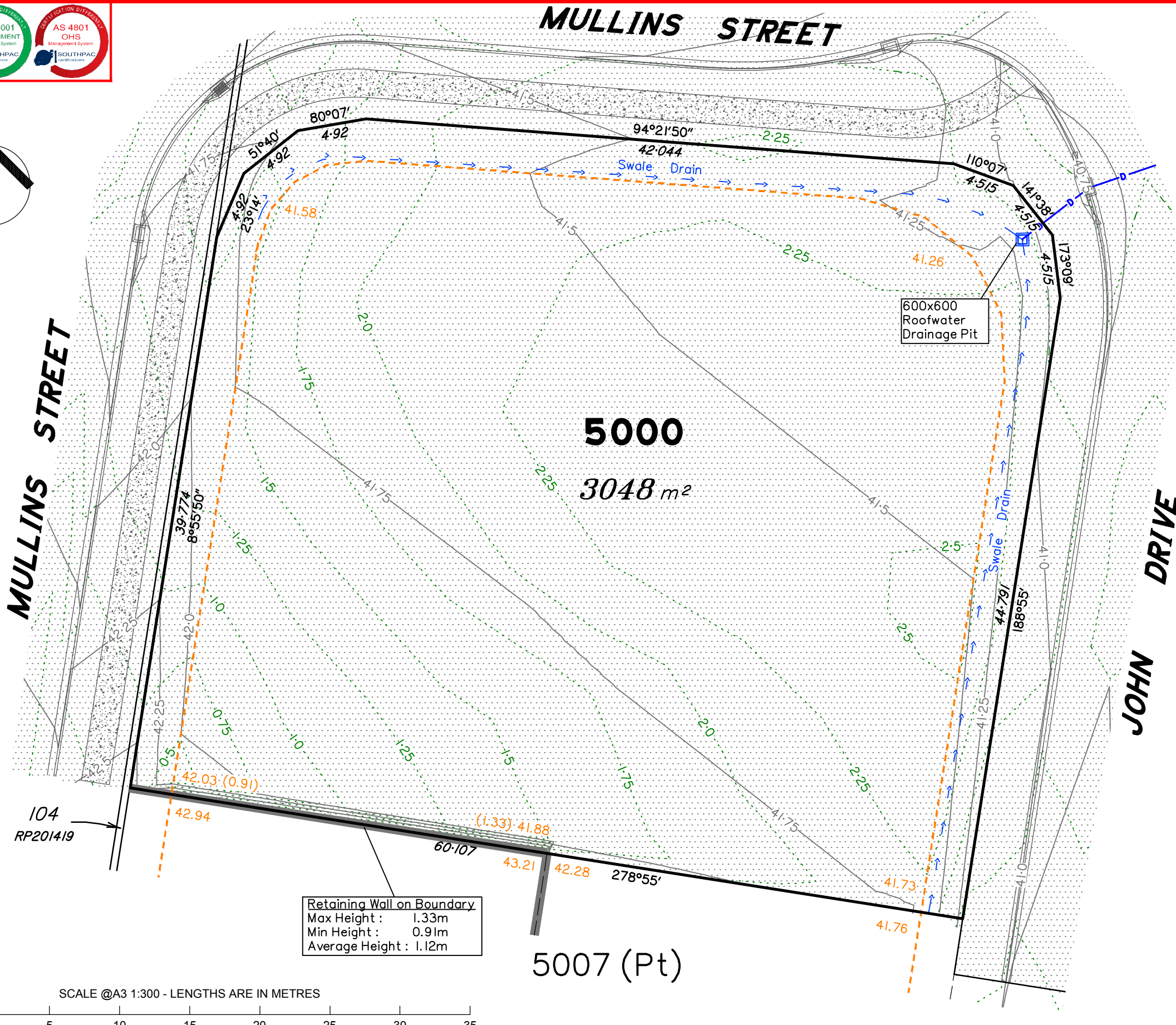
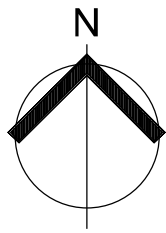

Retaining Wall on Boundary
 Max Height : 1.33m
 Min Height : 0.91m
 Average Height : 1.12m

5007 (Pt)

SCALE @A3 1:300 - LENGTHS ARE IN METRES

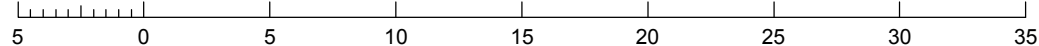

LEGEND

- Area of Cut
- Area of Fill
- Finished Surface Contours
- Depth of Fill Contours
- Retaining Wall
(Height shown on lower side of wall)
- Proposed Earthworks Pad
- 38.78 Finished Design Surface Level
- Future Lot Boundary

Not all items in this legend may be relevant to the lot shown on this plan.

NOTES

This plan has been prepared from preliminary survey plan (SP317659) and engineering data provided on the 21/07/2020 by Peak Urban Engineers.

Development approval has been received for this subdivision (application 2558/4/MAMC/C) from Ipswich City Council (13/06/2019).

Development approval has been granted for Operational Works for this lot.

All fill shall be placed and compacted in a controlled manner so that Level 1 level of responsibility may be achieved and certified as per AS3798-2007.

Issues	No.	by	Date	Description
A	TBG		25/06/20	Original Issue
B	TBG		21/07/20	Civil Update

Saunders Havill Group Pty Ltd ABN 24 144 972 949
 Brisbane • Springfield • Rockhampton
 head office 9 Thompson St Bowen Hills Q 4006
 phone 1300 123 5HG web www.saundershavill.com

• surveying • town planning • urban design • environmental management • landscape architecture

This Disclosure Plan is prepared for the sole purpose of satisfying the Disclosure requirements of the Land Sales Act and SHOULD NOT be used for any other purpose, particularly As-constructed purposes. This information is compiled from Design plans only, unless otherwise stated, and therefore is subject to final survey and construction of operational works.

Disclosure Plan for Proposed Lot 5000 on SP317659
 Described as part of Lot 5007 on SP312157
 Existing Title Reference: 51216954
 Locality of Collingwood Park (Ipswich City Council)

Level Datum: AHD der.
 Origin of Levels: PM203097
 RL of Origin: 45.557m
 Contour Interval: 0.25m
 Scale @A3 1: 300
 Dwg No. 6777 S 37 DP B_5000